



A comprehensive range  
of window blind systems  
designed with unique  
technical features and to  
the exacting specifications  
that active commercial  
environments demand.

[commercialblindsuk.com](http://commercialblindsuk.com)

## The blind systems range

A comprehensive range of window blind systems designed with unique technical features and to the exacting specifications that active commercial environments demand.



All blinds are carefully built to exacting standards, giving years of trouble free service. The superior design features and quality components enable them to be confidently specified for the most demanding environments.



## Child Safety

Compliance with child safety isn't simply a legal obligation, it is a moral responsibility. No one should have concerns over the safety of a blind, and so we exceed what is expected and required of us. All relevant blinds incorporating accumulation cord/chain controls are supplied fully compliant with current legislation, whether as individual components or as a finished product. Test certificates are available.

## Fabric Range

The fabric portfolio encompasses a vast range of fabrics and colour schemes; all of which are flame-retardant to current government standards. Fabric types include dimout, blackout, solar reflective, high performance sun-screen, and solar film upon request. A comprehensive range of fabric selectors are available upon request. All fabrics are available in both full roll and cut length quantities, and are distributed globally through a network of dealers and customers providing an unrivalled level of support.

## O&M Guide

All Roller Blinds are low maintenance. The components and mechanisms are made from durable materials and will not corrode through normal use.

In the event of damage, most components are easily replaceable. Fabrics are designed to have high levels of stability and colour fastness.

## The full range

### Roller Blinds 4

The roller blind programme is one of the most comprehensive available, ranging from vision panel blinds to heavy duty electric blinds.

### Cassette Blinds 20

Cassette blinds give a smooth contemporary style to any window, and help to protect the blind fabric.

### Blackout Units 36

Offering the ultimate in light exclusion, the range provides you with 100% light blocking capabilities.

### Insect Screens 42

Insect screens are an important contributor to the quality of life in many situations, both residential and commercial.

### Vertical Blinds 46

Vertical blinds are some of the most comprehensive available, ranging from slim, premium profiled units to heavy-duty electrically controlled blinds.

### Venetian Blinds 52

Venetian blinds provide a stylish, innovative and diverse shading solution.



## Roller Blinds

All blinds are carefully built to exacting standards, giving years of trouble-free service. The superior design features and quality components enable them to be confidently specified for the most demanding environments.

Many blinds feature vandal-resistant controls and mechanisms, and are frequently seen in hospitals, schools, colleges and other public buildings, as well as regular commercial and residential environments.

The roller blind programme is one of the most comprehensive available, ranging from miniature spring rollers for door vision panels to heavy-duty electric blinds for large glazed areas. The fabrics programme encompasses a vast range of fabrics, all of which are flame-retardant to government standards.

Fabric types include dim-out, black-out, solar reflective, sun-screen and solar film.

Our blinds are available in fully made to measure form completely ready for installing, or in individual component form - for ease of use within any in-house manufacturing facility. The full range is distributed globally through a network of partners providing an unrivalled level of support, and experienced installation and service teams to exceed your expectations.

<b>R20 Sidewinder</b>	<b>5</b>
<b>R20B Battery 7.4v DC</b>	<b>6</b>
<b>R20C Crank</b>	<b>7</b>
<b>R20M Electric 24v DC</b>	<b>8</b>
<b>R20S Braked Spring</b>	<b>9</b>
<b>R20W Light Duty Crank</b>	<b>10</b>
<b>R26 Overhead Corded</b>	<b>11</b>
<b>R40 Premium Sidewinder</b>	<b>12</b>
<b>R54 Heavy Duty Crank</b>	<b>13</b>
<b>R55 Heavy Duty Electric 230v AC</b>	<b>14</b>
<b>R56 Overhead Crank</b>	<b>15</b>
<b>R57 Overhead Electric 230v AC</b>	<b>16</b>
<b>VPF Vision Panel Flap</b>	<b>17</b>
<b>Wire Side-guiding System</b>	<b>17</b>
<b>Specification Guide</b>	<b>18</b>



this roller blind range comes with a Full Lifetime Warranty as standard.





## R20 Sidewinder

### Features:

The R20 sidewinder roller blind incorporates Slipstream® Technology (patent pending) and has a metal control chain as standard. There are white metal universal brackets for face, top or side fixing with a 32mm, 40mm or 45mm grooved aluminium barrel, depending on the size of the blind and fabric weight. Fabric is locked into a groove in the barrel, and features a white plastic bottom bar as standard. The bottom bar is covered with fabric at the front.

### Benefits:

Strength and simplicity make the R20 the first choice for a vast range of applications. The choice of barrel size means that the blind is always ideally matched to window size for optimum performance. Vandal resistant features includes Slipstream®: a friction reducing technology - smooth action operation, air cooled design and double spring function - providing you with enhanced hold, exceptional long life properties and advanced chain loading. Metal control chain, fabric locked into the barrel and bottom bar, and sturdy, attractive metal brackets with covers.

**Approved to work with the YewdaleKestrel® Anti-Ligature system.**

### Options:

32mm Slipstream® mechanisms in black, silver or brown; Extension brackets and bracket covers; Plastic control chain; Alternative bottom bars including fully fabric covered in aluminium or plastic, and Tear Drop aluminium in black, silver or white; Wire side-guiding system; White aluminium back bar; Channel side-guiding system; Fascia.

### Specification:

The R20 sidewinder roller blind incorporating Slipstream® Technology for enhanced hold, advanced loading and exceptional long life properties. Flame retardant fabric from the range, locked into grooved 32/40/45mm aluminium barrel along with white plastic bottom bar. Slipstream® Technology sidewinder control with metal control chain and white plastic bracket covers.

Please refer to NBS Plus N10 240.

BIM model  
available

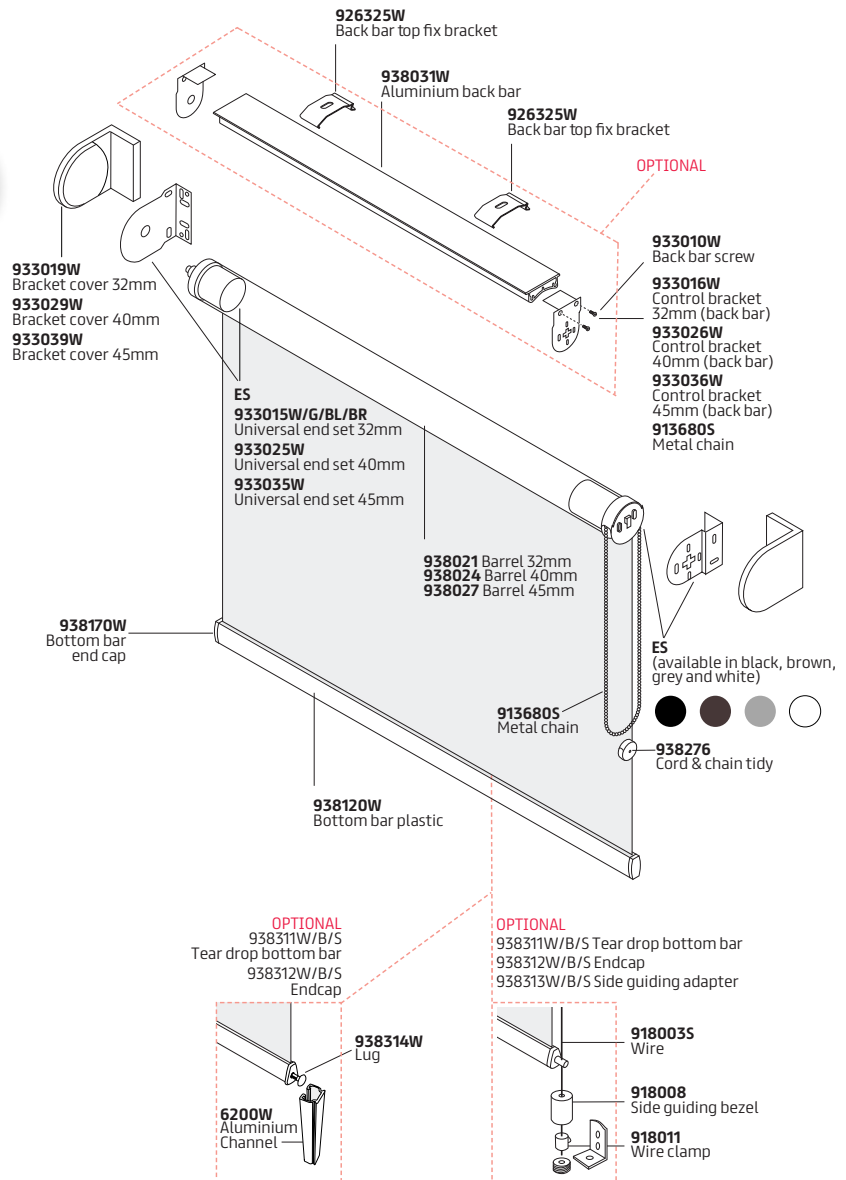

**have you seen all  
our fabrics?**

All our fabric selectors  
make choosing easy.  
Have you got the full set?

# Roller Blinds



## R20B Low Voltage Battery 7.4v DC

### Features:

The R20B electric roller blind comes with a low voltage battery motor as standard. The white metal brackets have plastic covers, for face or top fixing, on 40mm grooved aluminium barrel. The barrel houses a 7.4v DC motor with electronic limit stops and a slow stop/start feature. The motor is controlled by a remote switch (not supplied) and can be charged by either a mains charger (one supplied per order) or solar panel. The fabric is locked into a groove in the barrel, and it features a white plastic bottom bar as standard. The bottom bar is fabric covered at the front.

### Benefits:

A slim, reasonably priced blind with true fingertip control makes the R20B a perfect choice for motorised requirements including home automation. Its quiet and reliable motor houses a receiver, with simple radio control options operating the blind effortlessly. Housed within the barrel and supported by sturdy, metal brackets with attractive, slim plastic covers the motor is simply charged either by a charger or a solar panel making this one of the most eco-friendly blinds available. The fabric is locked into the barrel and bottom bar and will give years of trouble-free use.

### Options:

Fully fabric covered bottom bar; Alternative bottom bars, including fabric covered aluminium, and Tear Drop aluminium in black, silver or white. Group control systems; Wire side-guiding system; White aluminium back bar; Fascia.

### Specification:

R20B low voltage electric roller blind with low voltage battery 7.4v DC motor. Slim motor and spring end is housed within aluminium barrel supported by metal brackets with white plastic covers. Flame retardant fabric from the range, locked into grooved 40mm aluminium barrel along with white plastic bottom bar.

Please refer to NBS Plus N10 240.

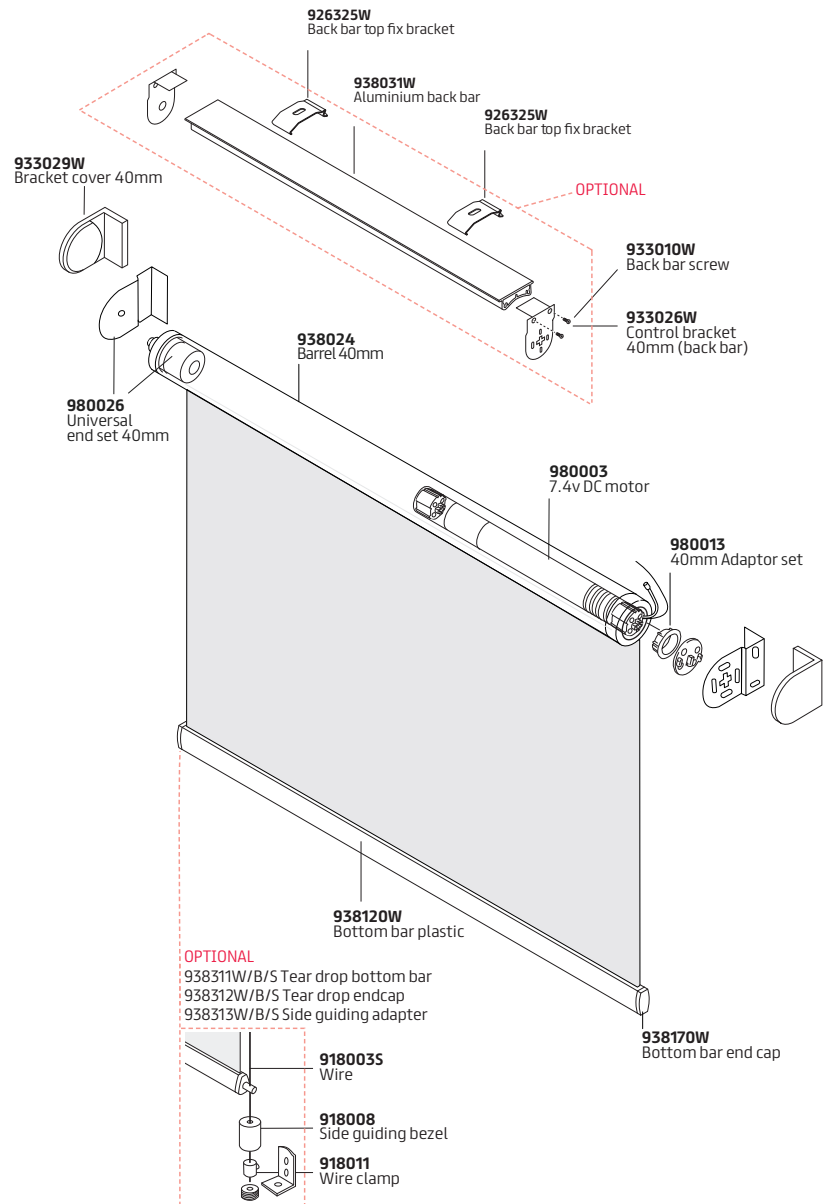



## R20C Crank

### Features:

The R20C crank control roller blind features a 45mm grooved aluminium barrel and white metal universal brackets for face or top fixing. A robust 1:5 crank mechanism ensures smooth blind control, and incorporates a magnetic detachable crank handle. The fabric is locked into a groove in the barrel, and features a white Tear Drop aluminium bottom bar as standard.

### Benefits:

Durability and simplicity make the R20C a good choice for a vast range of applications. The magnetic detachable crank ensures the blind is vandal resistant and safe for areas where cords are a threat. The fabric is locked into the barrel and bottom bar and supported by sturdy metal brackets.

**Approved to work with the YewdaleKestrel® Anti-Ligature system.**

### Options:

Alternative bottom bars including fully fabric covered in aluminium or plastic, and aluminium Tear Drop in black or silver; Wire side-guiding system; White aluminium back bar; Fixed crank handle; Channel side-guiding system; Fascia.

### Specification:

The R20C crank control roller blind with magnetic detachable crank handle. Robust vandal resistant 1:5 crank mechanism and pin end supported by white metal brackets. White metal brackets and covers. Flame retardant fabric from the range, locked into grooved 45mm aluminium barrel along with white Tear Drop aluminium bottom bar.

Please refer to NBS Plus N10 240.

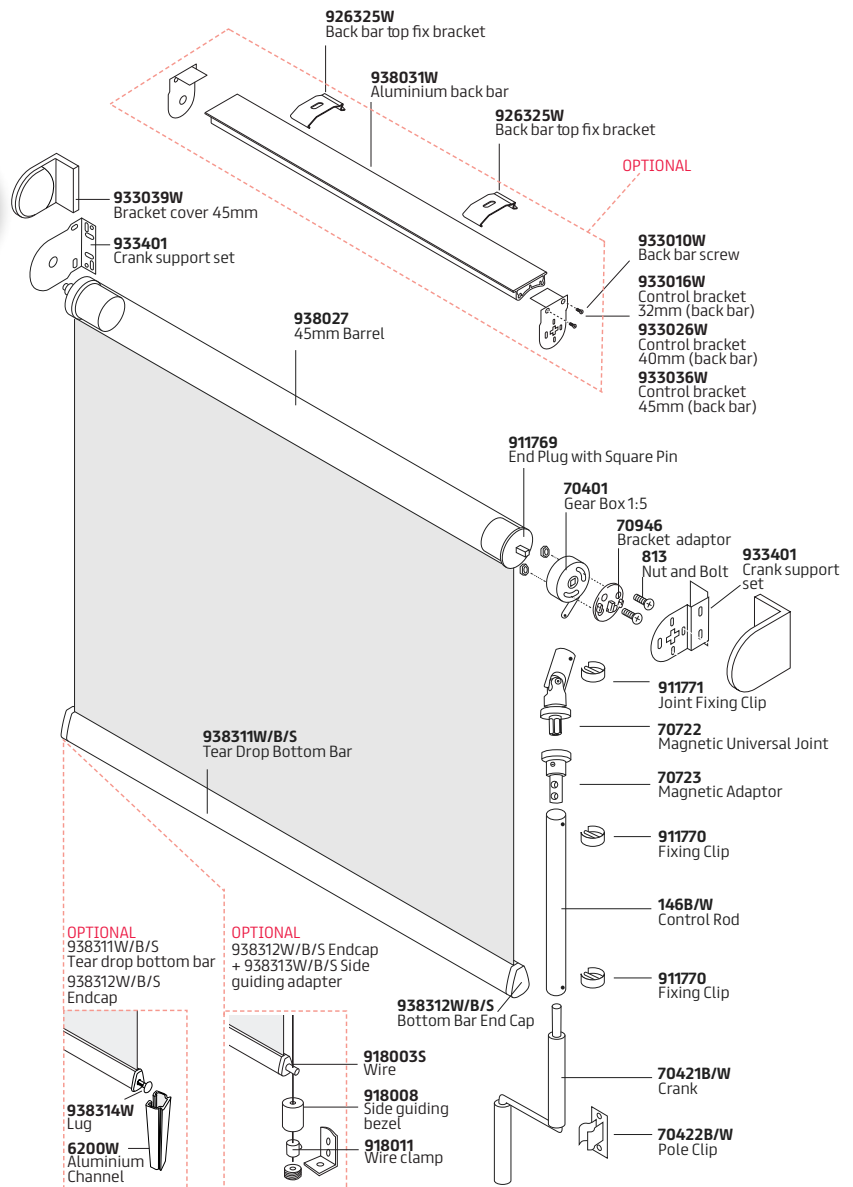

BIM model  
available



# Roller Blinds

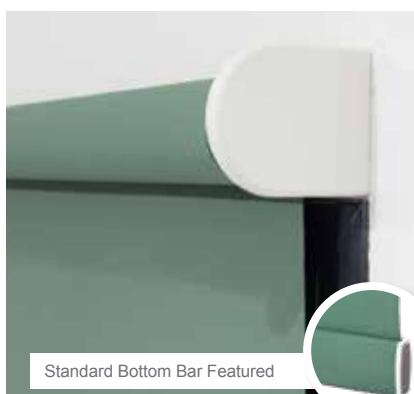

## R20M Low Voltage Electric 24v DC

### Features:

The R20M electric roller blind with a low voltage motor as standard. White metal brackets with plastic covers, for face or top fixing, on 40mm grooved aluminium barrel, housing a 24v DC motor with electronic limit stops and a slow stop/5start feature. The motor takes a 230v AC supply and is controlled by a remote switch (not supplied as standard). The fabric is locked into a groove in the barrel, and features a white plastic bottom bar as standard. The bottom bar is fabric covered at the front.

### Benefits:

A slim, reasonably priced blind with true fingertip control makes the R20M a perfect choice for motorised requirements including home automation. Its quiet and reliable motor houses a receiver and an inbuilt transformer enables a 230v feed to be used, it is controlled by simple remote switches. Housed within the barrel and supported by sturdy, metal brackets with attractive, slim plastic covers. The fabric is locked into a barrel and bottom bar and will give years of trouble-free use.

### Options:

Fully fabric covered bottom bar; Alternative bottom bars, including fabric covered aluminium, and Tear Drop aluminium in black, silver or white. Group control systems; Wire side-guiding system; White aluminium back bar; Channel side-guiding system; Fascia.

### Specification:

R20M low voltage electric roller blind with low voltage 24v DC motor. Slim motor and spring end is housed within aluminium barrel supported by white metal brackets. Flame retardant fabric from the range, locked into grooved 40/45mm aluminium barrel along with white plastic bottom bar.

Please refer to NBS Plus N10 240.

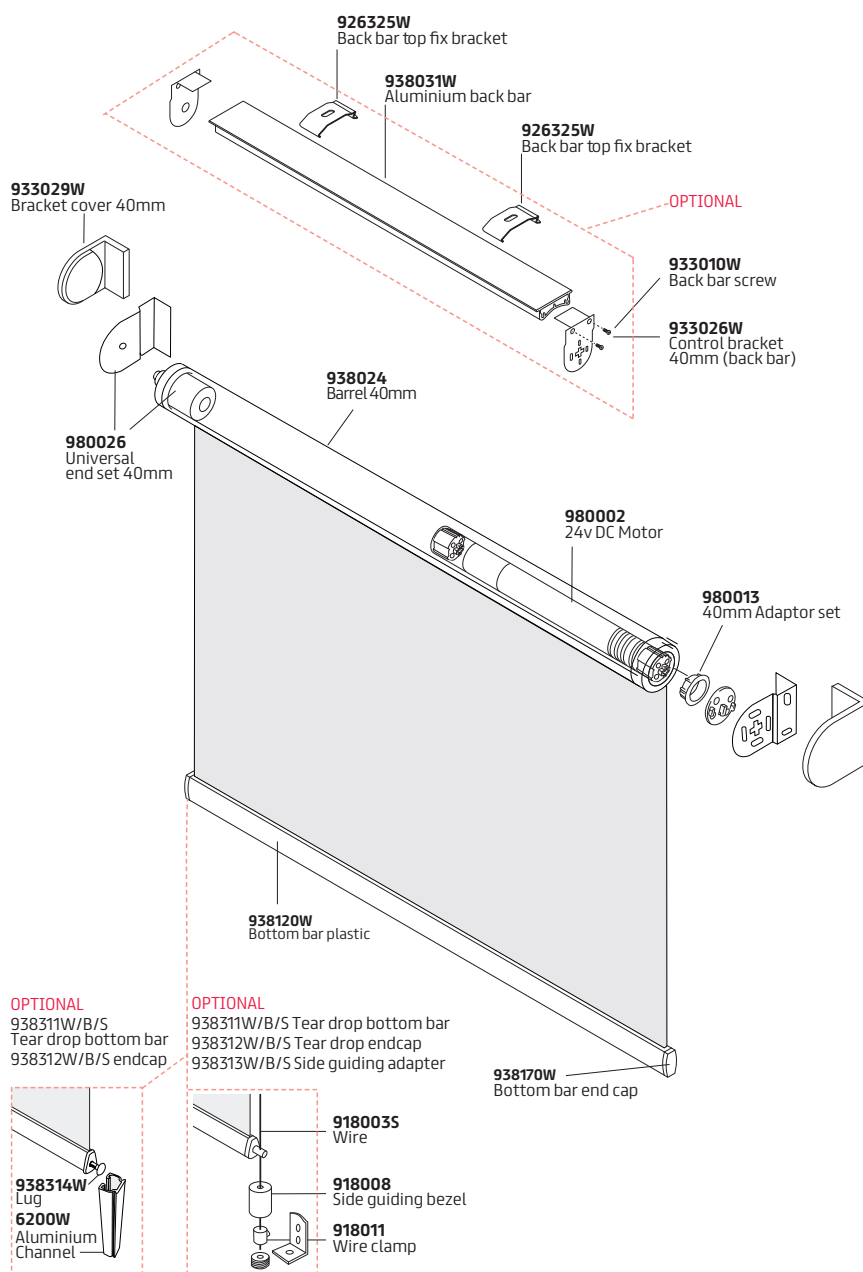



BIM model  
available

Standard Bottom Bar Featured

## R20S Braked Spring

### Features:

The R20S slow-rise spring roller blind promises smooth and quiet operation. White metal universal brackets for face or top fixing with 32mm grooved aluminium barrel. The fabric is locked into a groove in the barrel, and features a white Tear Drop aluminium bottom bar with cord pull as standard.

### Benefits:

Smooth and quiet operation makes the R20S an excellent choice for a vast range of applications. Where there is a need for child safety the R20S braked spring is the answer with the ease of use and the lack of cords, this provides the ultimate solution. The braked spring is enclosed within the barrel supported by sturdy, attractive metal brackets. Fabric is locked into barrel and bottom bar maintaining exceptional edge to edge coverage for even better shading properties.

**Approved to work with the YewdaleKestrel® Anti-Ligature system.**

### Options:

Spring limit stop; Alternative bottom bars, including fully fabric covered, in aluminium or plastic, and aluminium Tear Drop in black or silver; White aluminium back bar; Fascia.

### Specification:

The R20S braked spring control roller blind with vandal resistant, child friendly braked spring. Braked spring and spring end is housed within an aluminium barrel, supported by white metal brackets. Flame retardant fabric from the range, locked into grooved 32mm aluminium barrel along with white Tear Drop aluminium bottom bar.

Please refer to NBS Plus N10 240.

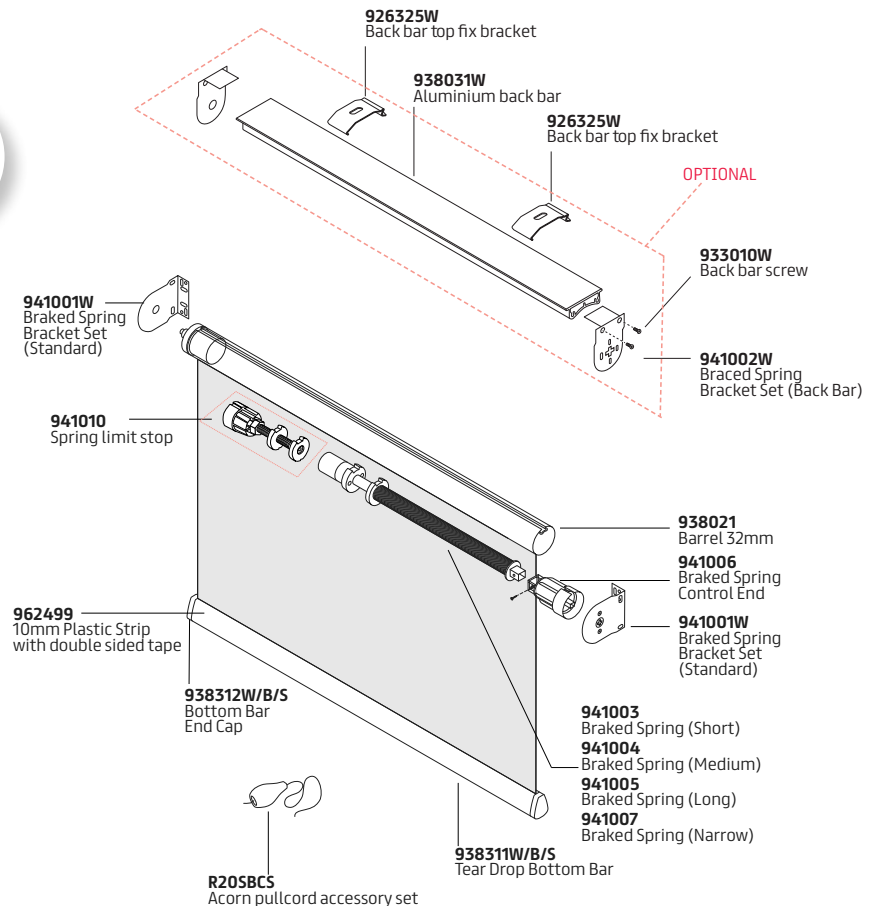

### have you seen all our fabrics?

All our fabric selectors make choosing easy. Have you got the full set?

# Roller Blinds



## R20W Light Duty Crank

### Features:

The R20W plastic crank controlled roller blind features a 40mm grooved aluminium barrel and white metal universal brackets for face or top fixing. The robust plastic wind mechanism ensures very smooth blind control, operated by a detachable handle. The fabric is locked into a groove in the barrel, and features a white plastic bottom bar as standard.

### Benefits:

Durability and simplicity make the R20W a good choice for a vast range of applications. The detachable handle ensures the blind is vandal resistant and safe for areas where cords are a danger. The fabric is locked into the barrel and bottom bar, supported by sturdy metal brackets, and the mechanism is encased within a plastic housing.

### Options:

Alternative bottom bars including fully fabric covered in aluminium or plastic, and aluminium Tear Drop in black or silver; Wire side-guiding system; White aluminium back bar; Fascia.

### Specification:

The R20W plastic crank controlled roller blind with detachable handle. Robust plastic wind mechanism and pin end enclosed within a plastic housing and supported by white metal brackets with covers. Flame retardant fabric from the range, locked into grooved 40mm aluminium barrel along with plastic bottom bar.

Please refer to NBS Plus N10 240.

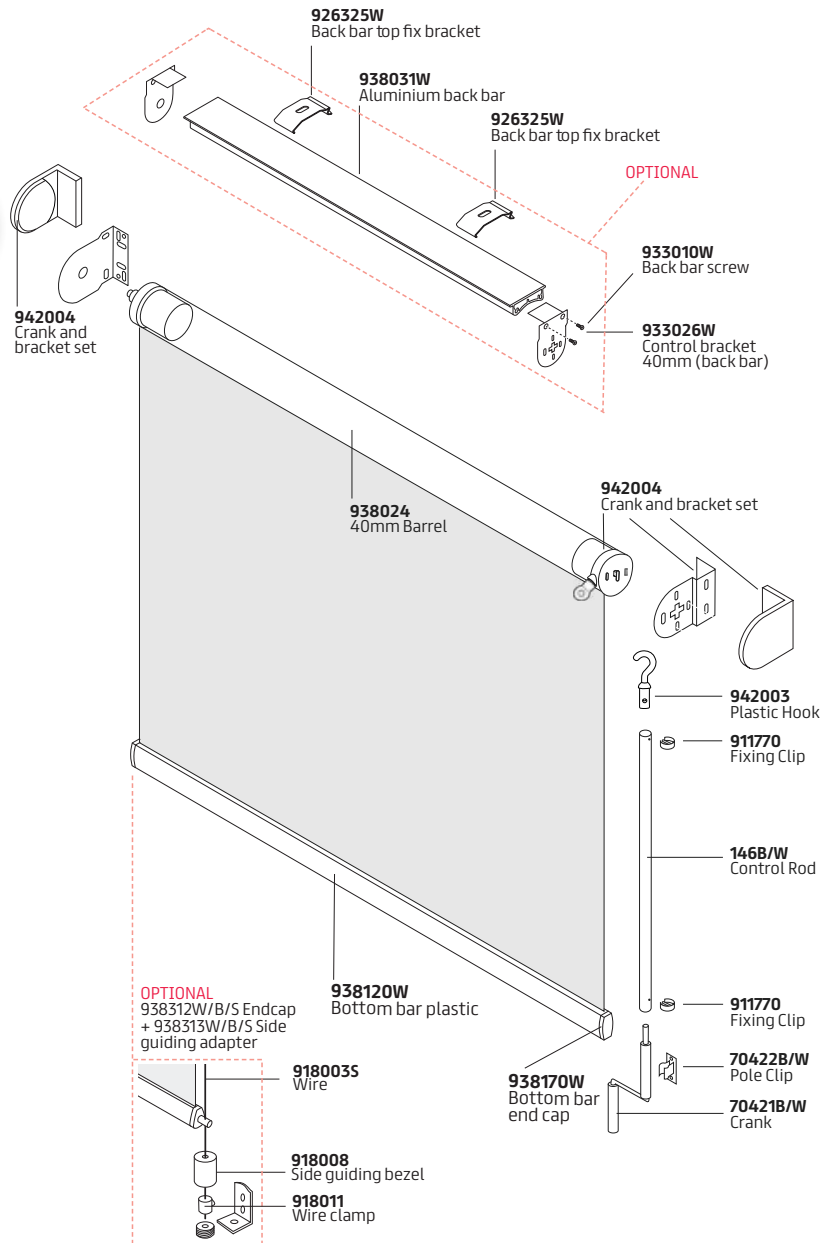



## R26 Overhead Corded

### Features:

The R26 overhead corded roller blind comes with a pull-cord and pulleys as standard. White plastic brackets for face or top fixing with 25mm aluminium barrel or white metal brackets for 57mm aluminium barrel, and strong, constant tension spring mechanism. The fabric is bonded onto the barrel, and features a white Tear Drop aluminium bottom bar. There is a pull-cord with cleat, and pulleys for single or double-corded operation.

### Benefits:

Ideal for relatively inaccessible locations, the R26 utilises tried and tested spring components and simple manual operation. Subject to size limitations, it is able to cope with sloping or even horizontal roof windows. The fabric is bonded to the barrel and locked into the bottom bar, and supported by sturdy brackets.

### Options:

Tear Drop aluminium bottom bar in black or silver.

### Specification:

R26 overhead corded roller blind with constant tension spring mechanism. Complete with pull-cord, cleat and pulleys for overhead operation, supported by sturdy white brackets. Flame retardant fabric from the range, on aluminium barrel with spring operation for single or double-handed use. Complete with pull-cord, cleat and pulleys for overhead operation.

Please refer to NBS Plus N10 240.

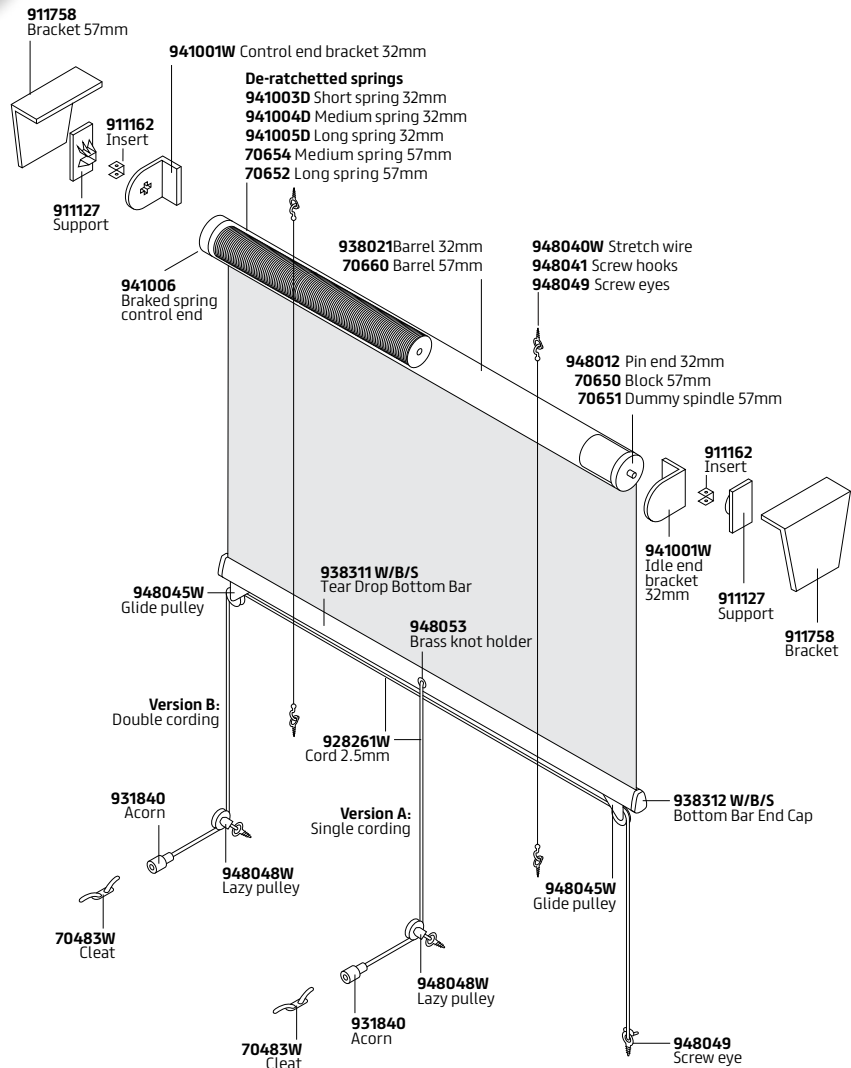

# Roller Blinds



## R40 Premium Sidewinder

### Features:

The R40 heavy duty roller blind with premium sidewinder mechanism as standard. Choose between white plastic brackets for face or top fixing with 36mm grooved aluminium barrel, or white metal brackets with 53mm or 70mm grooved aluminium barrel, depending on blind size and fabric weight. Superior quality 1:4 geared sidewinder mechanisms for heavy duty operation, with metal control chain. The fabric is locked into a groove in the barrel and features a white Tear Drop aluminium bottom bar as standard.

### Benefits:

The R40 opens up a whole range of premium quality sidewinder controlled blinds. The control mechanisms are meticulously designed for a long and trouble-free life, and the wide choice of barrel sizes, ranging from the attractively slim 36mm to the extremely rigid 70mm, means that there is a superbly engineered sidewinder blind for almost every application. The fabric is located in the groove in such a way that, although it cannot be pulled out, it may be slid out sideways for easy repair or replacement.

### Options:

Alternative bottom bars, in plastic or aluminium, including fabric covered; Tear Drop aluminium bottom bar in black or silver; Wire side-guiding system; White aluminium back bar; Fascia.

### Specification:

R40 premium sidewinder roller blind with superior quality 1:4 geared sidewinder mechanism for heavy duty operation. Flame retardant fabric from the range, locked into grooved 36/53/70mm aluminium barrel along with white Tear Drop aluminium bottom bar as standard. Supported by sturdy, attractive brackets and incorporating metal control chain.

Please refer to NBS Plus N10 240.

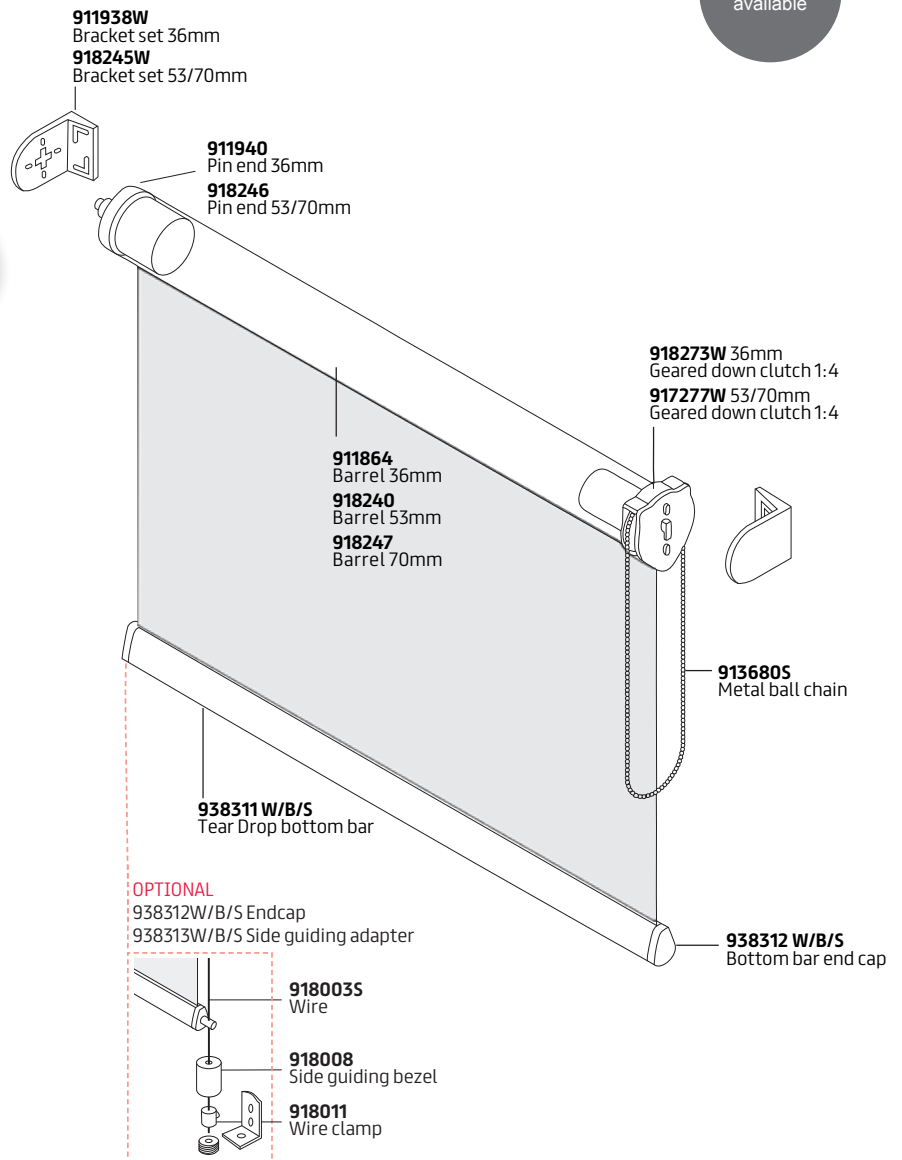

BIM model  
available



## have you seen all our fabrics?

All our fabric selectors make choosing easy. Have you got the full set?



Standard Bottom Bar Featured

## R54 Heavy Duty Crank

### Features:

The R54 crank control roller blind features a heavy duty 1:3 crank mechanism for effective operation of large blinds. Operated by a magnetic detachable crank handle, and accommodating robust grooved aluminium barrel, this system is built to last. Choose from white plastic covered brackets or metal brackets for face or top fixing, and with 53mm or 70mm grooved aluminium barrel, depending on blind size and fabric weight. The fabric is locked into a groove in the barrel, and features a white Tear Drop aluminium bottom bar as standard.

### Benefits:

The strongest manual control blind from the range. The R54 is designed to cope, and built to last. Fabric is located in the groove in such a way that, although it cannot be pulled out it may be slid out sideways for easy repair or replacement of blind cover. The removable crank means that the blind cannot be tampered with by unauthorised personnel. Ideal for situations when a large blind size is required, or when vandal-resistance is a priority.

### Options:

Alternative bottom bars in aluminium, including fabric covered; Tear Drop aluminium bottom bar in black or silver; Wire side-guiding system; Fixed crank handle.

### Specification:

R54 Heavy duty crank control roller blind with heavy duty 1:3 crank mechanism. Flame retardant fabric from the range, locked into grooved 53/70mm aluminium barrel along with white Tear Drop aluminium bottom bar as standard. Supported by sturdy brackets and incorporating magnetic detachable crank handle.

Please refer to NBS Plus N10 240.

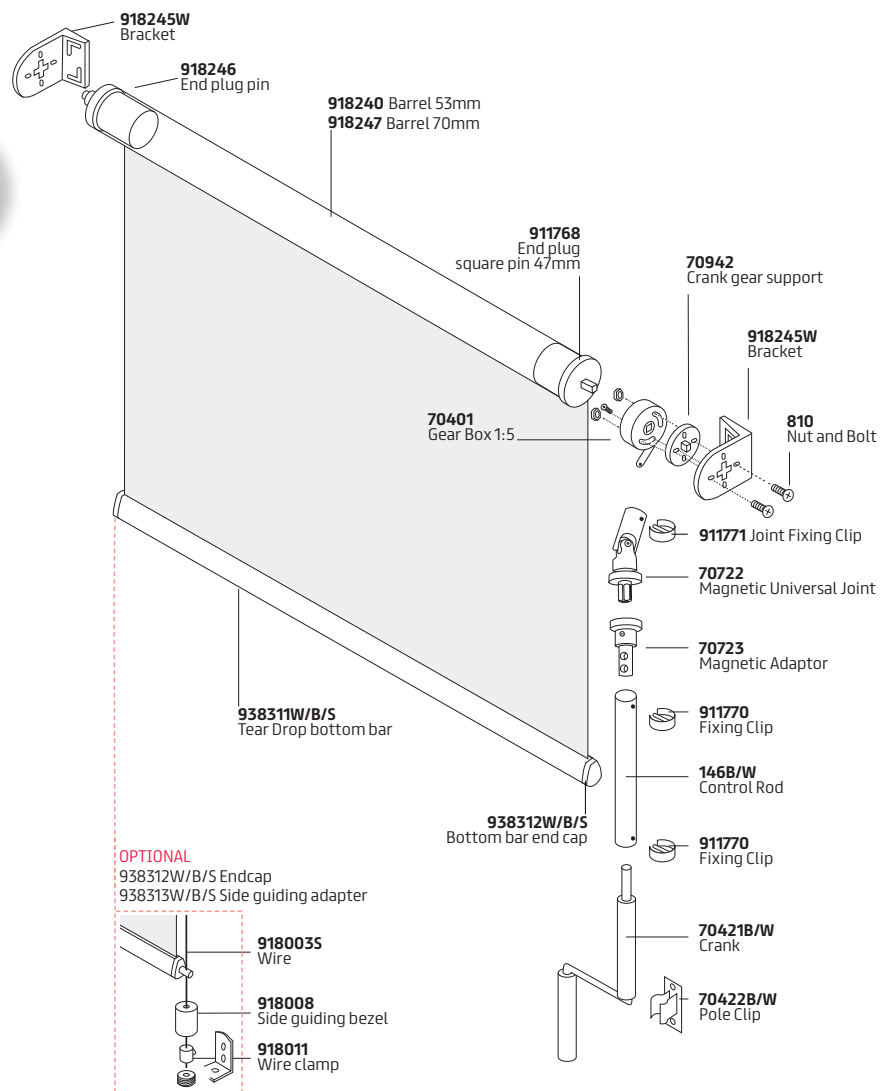

# Roller Blinds



## R55 Heavy Duty Electric 230v AC

### Features:

The R55 electric roller blind with a 230v AC motor as standard. White plastic covered, metal brackets for face or top fixing with 53 or 70mm grooved aluminium barrel, depending on blind size and fabric weight, housing a powerful 230v AC motor. The motor is controlled by a switch which may be surface or flush mounted (not supplied as standard). The fabric is locked into a groove in the barrel and features a white Tear Drop aluminium bottom bar as standard.

### Benefits:

The R55 offers a premium roller blind for situations where strength and ease of use are paramount. Its quiet and reliable motor is housed within the barrel and supported by sturdy metal brackets. The fabric is locked into the barrel and bottom bar in such a way that, although it cannot be pulled out, it may be slid out sideways for easy repair or replacement of blind cover. A large number of control options are available, including remote control and home automation systems enabling the specifier to integrate the window shading element into an overall scheme of electrical control systems.

### Options:

Alternative bottom bars in aluminium, including fabric covered; Tear Drop aluminium bottom bar in black or silver; Wire side-guiding system; Remote and/or group control systems.

### Specification:

R55 heavy duty electric roller blind with 230v AC motor. Slim motor is housed within aluminium barrel supported by metal brackets with white plastic covers. Flame retardant fabric from the range, locked into grooved 53/70mm aluminium barrel along with white Tear Drop aluminium bottom bar as standard.

Please refer to NBS Plus N10 240.

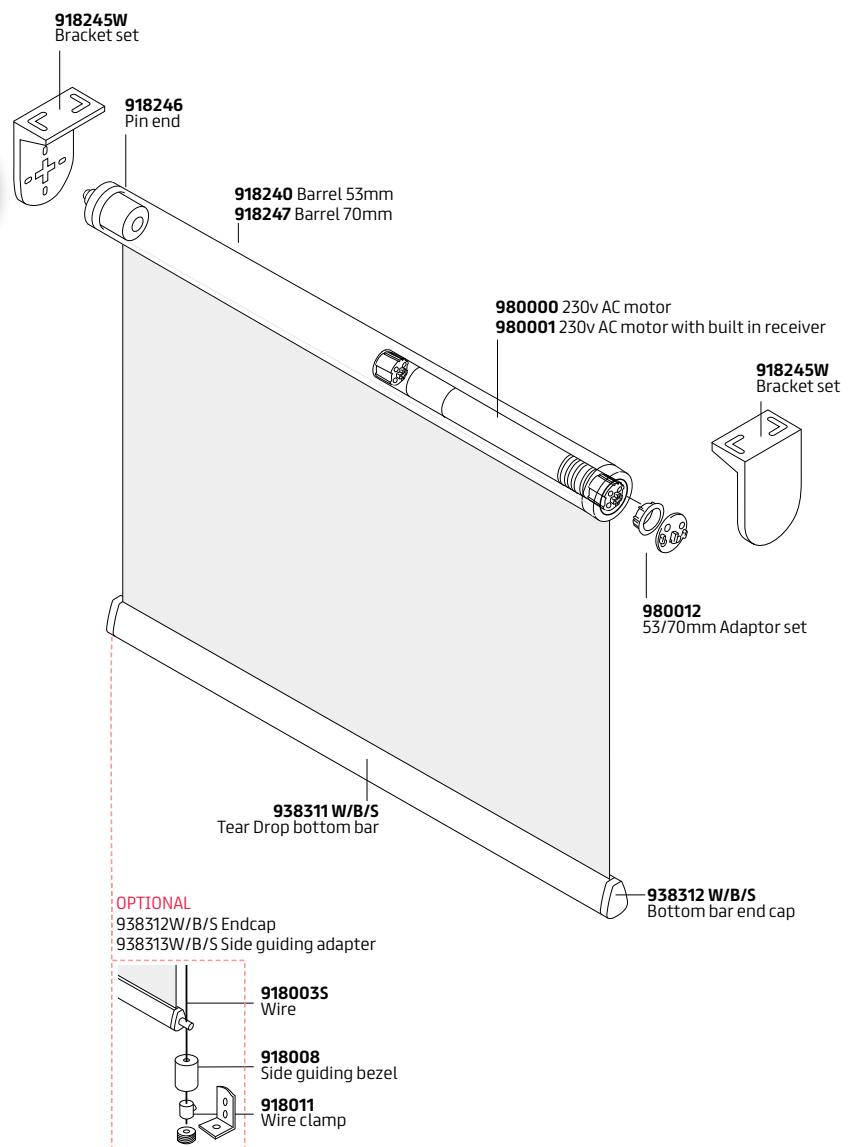

## have you seen all our fabrics?

All our fabric selectors make choosing easy. Have you got the full set?



Standard Bottom Bar Featured

## R56 Overhead Crank

### Features:

The overhead roller blind system with crank operation. White aluminium brackets for top or face fixing with 50 and 57mm grooved aluminium barrels. Fabric is mounted onto a sprung 57mm aluminium barrel whilst at the other end it is fitted to a white Tear Drop aluminium bottom bar, attached to two draw tapes. These tapes are attached, between flanged guides, to the 50mm drive barrel, operated by 1:4 gear control mechanism and crank handle.

### Benefits:

The R56 roller blinds are the ultimate in choice for the shading requirements for sloping or horizontal roof windows. With heavy duty componentry and a powerful spring action to the fabric roller, these blinds may be confidently specified for awkward or inaccessible locations. The magnetic detachable crank handle provided with the R56 removes the common issues associated with locating the drive at height and solves the problem of unauthorised use.

### Options:

Tear Drop aluminium bottom bar in black or silver; Channel side-guiding system; Fixed crank handle.

### Specification:

R56 crank operation overhead roller blind with 1:4 geared crank mechanism. Flame retardant fabric from the range, on 57mm aluminium barrel with enclosed spring attached to white Tear Drop aluminium bottom bar as standard. 50mm drive barrel connected to gear control crank mechanism operates blind by means of draw-tapes to the bottom bar. Supported by sturdy, attractive brackets and incorporating magnetic detachable crank handle.

Please refer to NBS Plus N10 240.

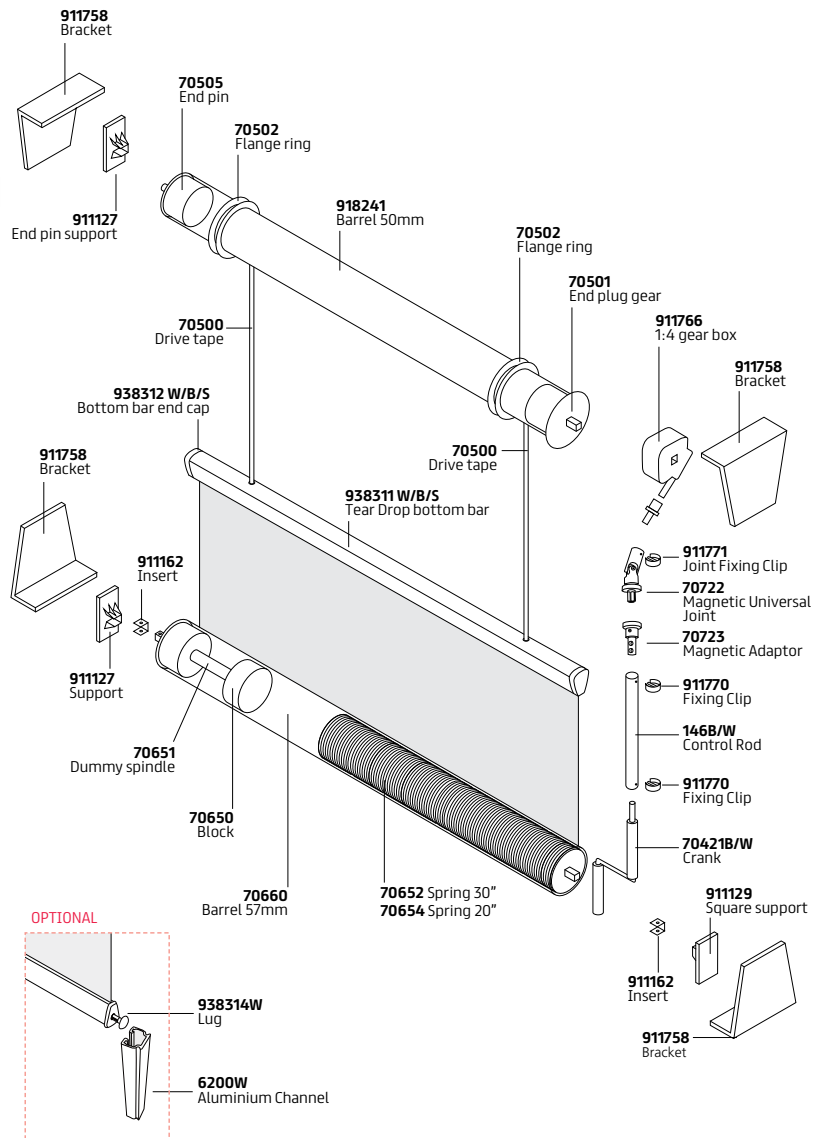



# Roller Blinds



## R57 Overhead Electric

### Features:

The overhead roller blind system with 230v AC motor. White aluminium brackets for top or face fixing with 50 and 57mm grooved aluminium barrels. The motor is controlled by a switch which may be surface or flush mounted (not supplied). Fabric is mounted onto a sprung 57mm aluminium barrel whilst at the other end it is fitted to a white Tear Drop aluminium bottom bar, attached to two draw tapes. These tapes are attached, between flanged guides, to the 50mm drive barrel, operated by a 230v AC electric motor.

### Benefits:

The R57 roller blinds are the ultimate in choice for the shading requirements for sloping or horizontal roof windows. With heavy duty componentry and a powerful spring action to the fabric roller, these blinds may be confidently specified for awkward or inaccessible locations. The R57 can be supplied with a number of remote or group control options including Radio Control and home automation systems.

### Options:

Tear Drop aluminium bottom bar in black or silver;  
Remote and/or group control systems.

### Specification:

R57 electric operation overhead roller blind with 230v AC motor. Flame retardant fabric from the range, on 57mm aluminium barrel with enclosed spring attached to white Tear Drop aluminium bottom bar as standard. 50mm drive barrel connected to electric motor operates blind by means of draw-tapes to the bottom bar. Supported by sturdy, attractive brackets.

Please refer to NBS Plus N10 240.

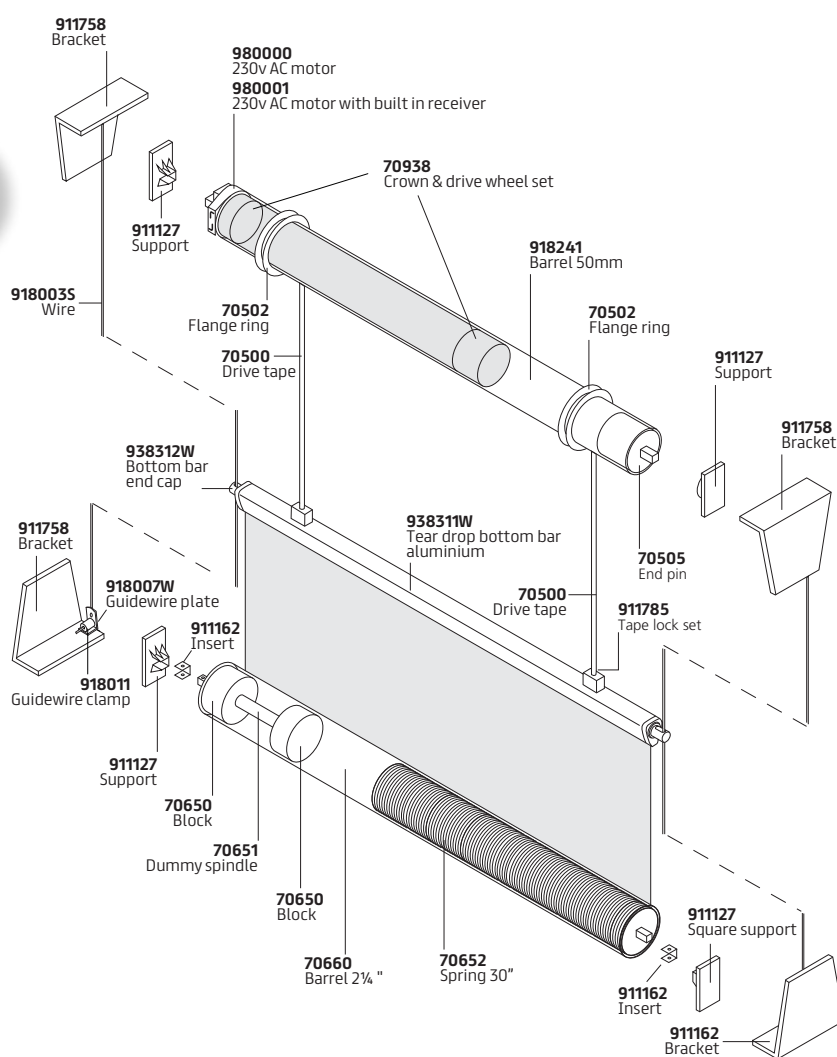

### have you seen all our fabrics?

All our fabric selectors make choosing easy.  
Have you got the full set?



## VPF Vision Panel Flap

### Features:

The vision panel flap comes with turn-button control as standard. White plastic turn-buttons to each corner secures the fabric privacy screen in place when in use. The fabric has stitched hems on the top and bottom, and a central turn-button at the top for retaining when not in use.

### Benefits:

The Vision Panel Flaps offer a discreet screen on doors/windows without the need of mechanisms - especially important where there are space restrictions. These are seen as infection control friendly as they can be easily removed and replaced for cleaning purposes. Light seepage is kept to a minimum due to the closeness of fabric to the glass.

### Options:

Velcro strip bonded to top and bottom edges in place of turn-button and tag; Shaped panels.

### Specification:

Vision Panel Flap from flame retardant fabric. Flame retardant fabric from the fabric range with stitched hems to top and bottom. Retained by turn-button tag control to each corner for effective screening.

Please refer to NBS Plus N10 240.

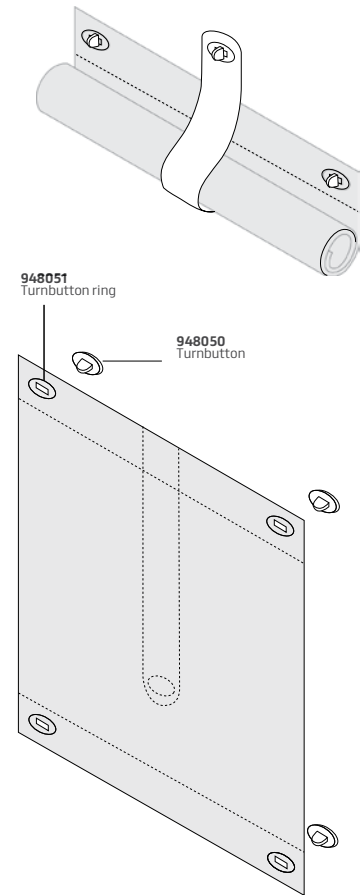

## Wire Side-guiding System

### Features:

The wire side-guiding system was developed to ensure that roller blinds could be kept in a closed position regardless of the forces of gravity or movement of air around it. The rotatable bottom bar end-cap adaptor is held securely to the stainless steel wire, which provides the robust positioning mechanism; this, in turn, is held under tension by a metal bezel.

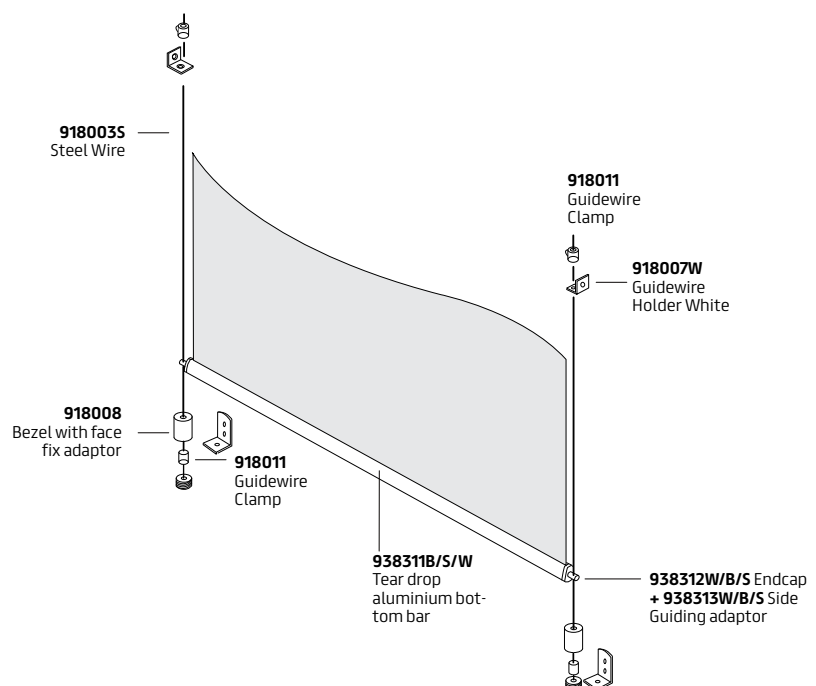

# Roller Blinds

## Roller Blind Specification Guide

Code	Description	Min Width	Max Width	Max Drop	Max M <sup>2</sup>
R20	Sidewinder	200	3450	4250	6.5
R20B	Low Voltage Battery 7.4v DC	500	2650	3350	4.8
R20C	Crank	200	3450	4250	6.5
R20M	Low Voltage Electric 24v DC	500	2650	3350	4.8
R20S	Braked Spring**	450	1850	2450	4.3
R20W	Light Duty Crank	200	2650	3350	5.0
R26-25	Overhead Corded - 25mm	500	1850	1850	3.5
R26-57	Overhead Corded - 57mm	720	2500	2850	5.0
R40-36	Premium Sidewinder - 36mm	200	2600	3600	6.5
R40-53	Premium Sidewinder - 53mm	200	3450	3450	9.0
R40-70	Premium Sidewinder - 70mm	200	4700	5750	10.0
R54-53	Heavy Duty Crank - 53mm	200	3450	3450	9.0
R54-70	Heavy Duty Crank - 70mm	200	4700	5750	10.0
R55-53	Heavy Duty Electric 230v AC - 53mm	570	3450	3450	9.0
R55-70	Heavy Duty Electric 230v AC - 70mm	570	4700	5750	10.0
R56	Overhead Crank	720	2500	2000	4.0
R57	Overhead Electric 230v AC	720	2500	2000	4.0

Based on fabric weight of 220g/m<sup>2</sup>, e.g. Thames. Use of heavier fabrics may require appropriate reductions.

\*\* Use of limit stop may require appropriate reductions.



## Cassetted Blinds

All blinds are carefully built to exacting standards, giving years of trouble-free service. The superior design features and quality components enable them to be confidently specified for the most demanding environments.

Many blinds feature vandal-resistant controls and mechanisms, and are frequently seen in hospitals, schools, colleges and other public buildings, as well as the regular commercial and residential environments.

Cassetted blinds give a smooth contemporary style to any window, and help to protect the blind fabric from dust or damage. The C2 range of cassettes offer a pleasing and modern alternative to standard roller blinds incorporating an attractive aluminium head-box to protect and enclose the fabric when it's not in use for its shading purposes. The C4 cassette range includes side channels as standard. These help to retain the fabric in position, and will also give a degree of light exclusion when used in conjunction with blackout fabric.

The full range is distributed globally through a network of partners providing an unrivalled level of support, and with experienced installation and service teams to exceed your expectations.

<b>C20 Sidewinder</b>	<b>21</b>
<b>C22 Braked Spring</b>	<b>22</b>
<b>C24 Crank</b>	<b>23</b>
<b>C25 Electric 24v</b>	<b>24</b>
<b>C27 Electric 230v</b>	<b>25</b>
<b>C40 Sidewinder</b>	<b>26</b>
<b>C42 Braked Spring</b>	<b>27</b>
<b>C44 Crank</b>	<b>28</b>
<b>C45 Electric 24v</b>	<b>29</b>
<b>C47 Electric 230v</b>	<b>30</b>
<b>C56T Overhead Crank</b>	<b>32</b>
<b>C57T Overhead Electric</b>	<b>33</b>
<b>Laser Blinds</b>	<b>34</b>
<b>Tracker Fabric Retaining System</b>	<b>34</b>
<b>Specification Guide</b>	<b>35</b>



this cassetted blind range comes with a Full Lifetime Warranty as standard.





## C20 Sidewinder

### Features:

All of the C20 sidewinder cassetted blinds come with an enclosed aluminium head-box as standard. This cassette is designed for top or face fixing and accommodates 32, 45, 53 or 70mm grooved aluminium barrels, depending on blind size and fabric weight. Fabric is locked into a groove in the barrel, and features an aluminium bottom bar. A robust Slipstream® sidewinder mechanism provides the effective means of operation with the use of metal control chain, held in place by a chain tidy. Black or white hardware as standard.

### Benefits:

The excellent performance of a cassetted blind is further enhanced as an aesthetically pleasing solution. The quality sidewinder mechanisms are simple to operate and allow accurate control of blind position.

### Options:

Black or white hardware; With side channels, C40-60/90/120. Wire side-guiding system; Available in any RAL colour.

### Specification:

C20-60/90/120 cassetted blind. Flame retardant fabric from the range, locked into grooved 32/45/53/70mm aluminium barrel along with aluminium bottom bar as standard. Black/white aluminium cassette and bottom bar and incorporating metal control chain.

Please refer to NBS Plus N10 240.

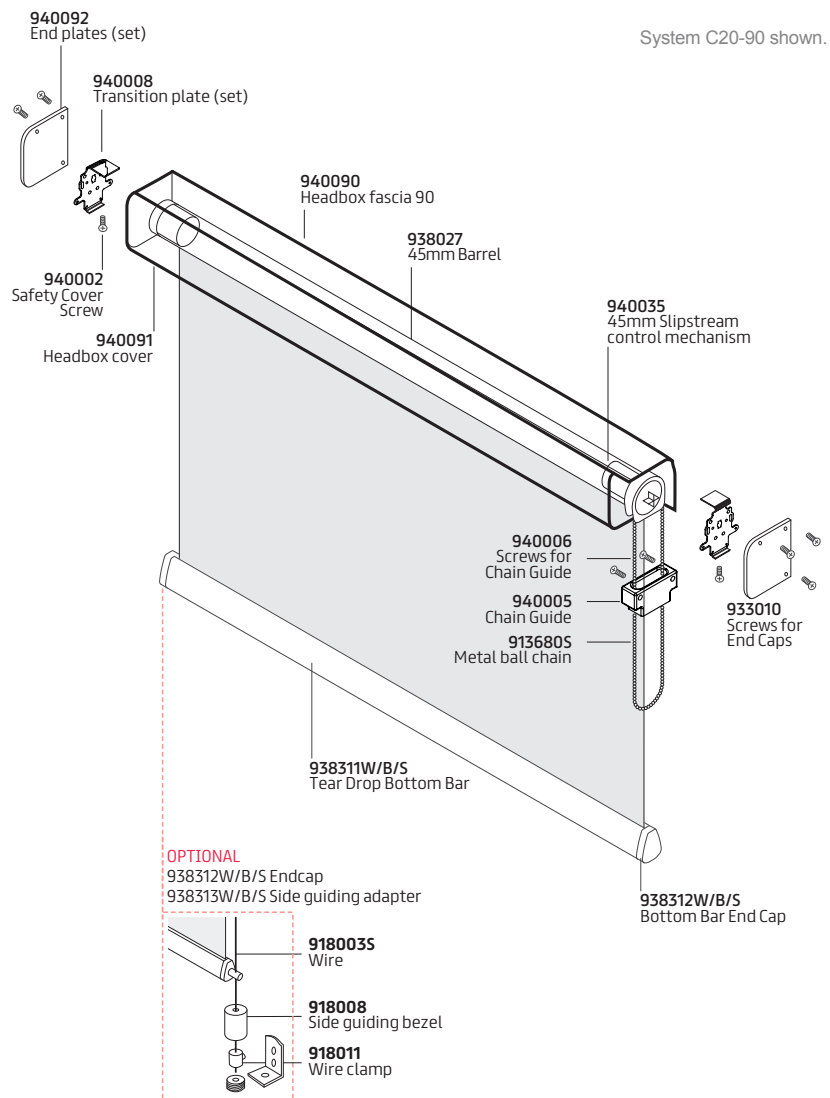

## Cassetted Blind Profile Dimension Guide

Model	Cassette Size (HxD)	Barrel Size Ø	Side Channel Size (WxD)
C20-60	77 x 73mm	32mm	n/a
C20-90	105 x 95mm	45mm	n/a
C20-120	140 x 120mm	53 / 70mm	n/a

# Cassette Blinds



Standard Bottom Bar Featured

## C22 Braked Spring

### Features:

The C22 cassetted braked spring roller blind with premium quality spring and decelerator ensures smooth and quiet operation. Direct fix for top and face applications. The fabric is locked into a groove in the 32mm aluminium barrel, and features an aluminium Tear Drop bottom bar. Click stops hold the blind at closed position. Black or white hardware as standard.

### Benefits:

An attractive metal-framed blind with the added appeal of slow-rise, or braked, technology. Generally used in dim-out applications with blackout fabric, or as an insect screen with mesh fabric, as it has no mid-point stopping positions. The braked spring and decelerator mechanism is enclosed within the barrel.

### Options:

Black or white hardware available in any RAL colour; With side channels C42-60.

### Specification:

C22-60 braked spring control cassetted blind. Flame retardant fabric from the range, locked into grooved 32mm aluminium barrel along with aluminium bottom bar as standard. Vandal resistant braked spring and spring end housed within black/white aluminium cassette.

Please refer to NBS Plus N10 240.

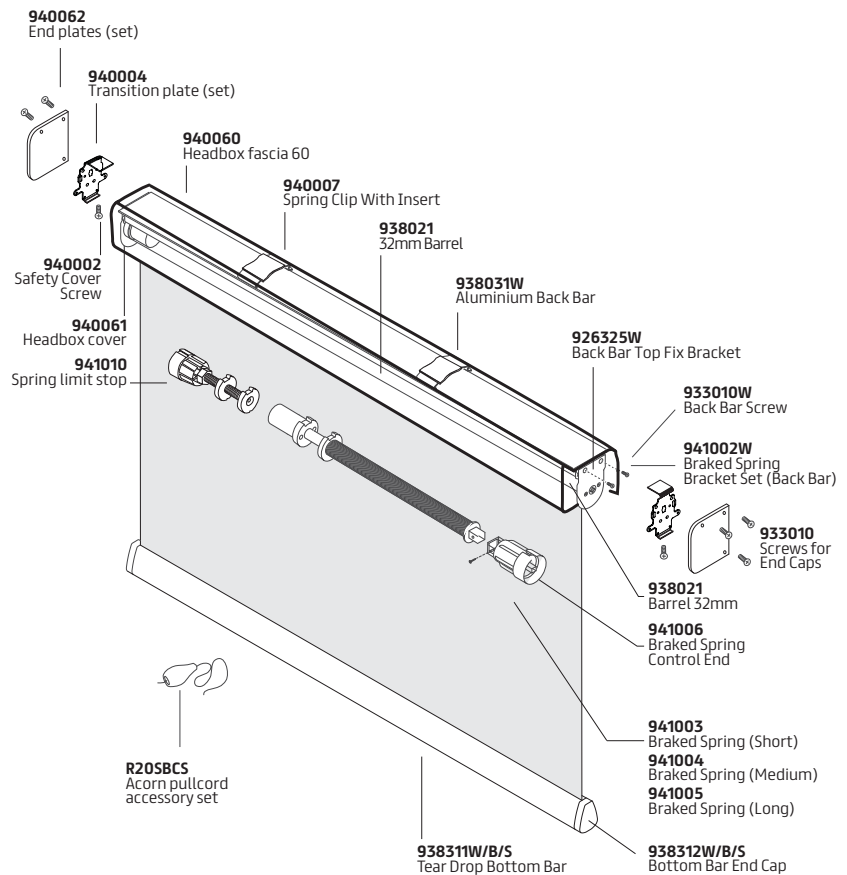

## Cassette Blind Profile Dimension Guide

Model	Cassette Size (HxD)	Barrel Size Ø	Side Channel Size (WxD)
C22-60	77x 73mm	32mm	n/a





Standard Bottom Bar Featured

## C24 Crank

### Features:

The C24 crank control cassetted blind features a compact, robust 1:3 gear mechanism operated by a detachable crank handle. The cassette is designed for top or face fixing and accommodates 45, 53 or 70mm grooved aluminium barrels, depending on blind size and fabric weight. The fabric is locked into a groove in the barrel. It has an aluminium Tear Drop bottom bar and black or white hardware as standard.

### Benefits:

Durability and simplicity make the C24 a good choice for a vast range of applications. With its powerful gear controls it will perform dependably in all kinds of contract applications. The geared crank handle and mechanism ensures smooth blind control and is safer for areas where cords are a threat. Fabric locked into the barrel and bottom bar and supported by sturdy supports.

### Options:

Black or white hardware; Fixed crank handle; With side channels C44-90/120. Wire side-guiding system; Available in any RAL colour.

### Specification:

C24-90/120 crank control cassetted blind. Flame retardant fabric from the range, locked into grooved 45/53/70mm aluminium barrel along with aluminium bottom bar as standard. Robust vandal resistant 1:3½ crank mechanism and pin end housed within black/white aluminium cassette, supported by sturdy brackets.

Please refer to NBS Plus N10 240.

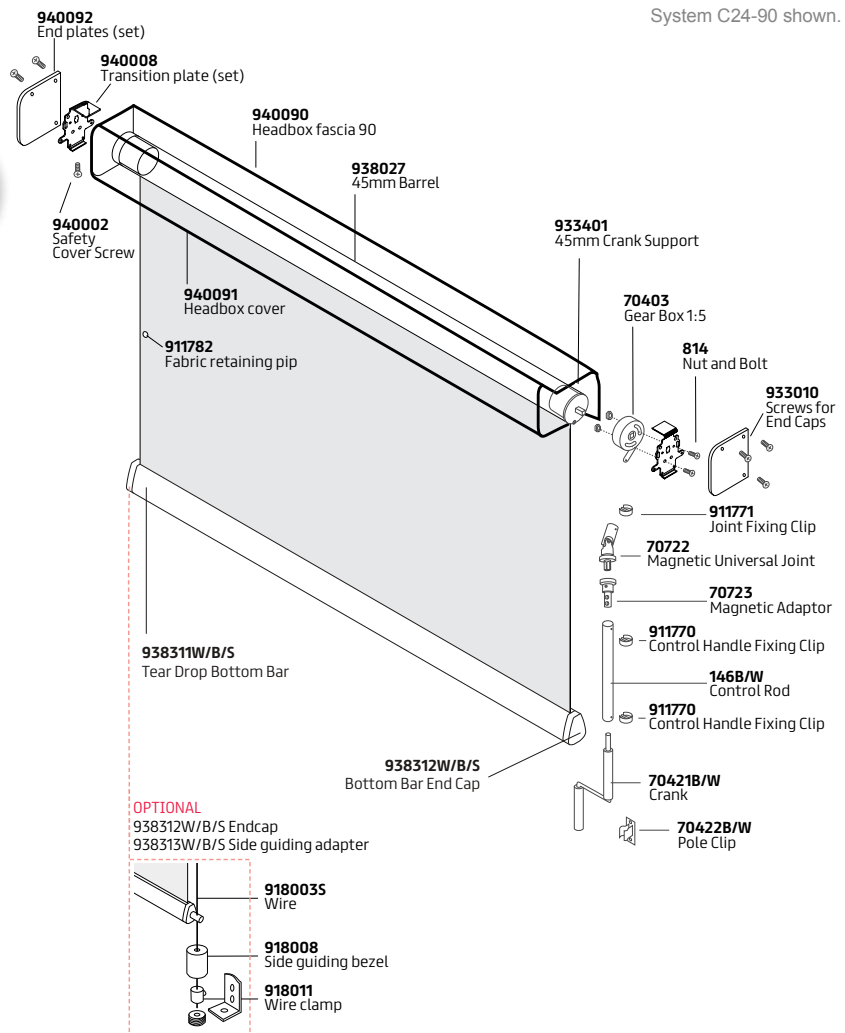

System C24-90 shown.

## Cassetted Blind Profile Dimension Guide

Model	Cassette Size (HxD)	Barrel Size Ø	Side Channel Size (WxD)
C24-90	105 x 95mm	45mm	n/a
C24-120	140 x 120mm	53 / 70mm	n/a

# Cassetted Blinds



Standard Bottom Bar Featured

## C25 Electric 24v

### Features:

The C25 electric cassetted blind features a low voltage 24v DC motor as standard. Cassette is designed for top or face fixing and accommodates a 40mm grooved aluminium barrel, housing the 24v DC motor. The motor is controlled by a switch which may be surface or flush mounted (not supplied as standard). Fabric is locked into a groove in the barrel and an aluminium bottom bar. Black or white hardware as standard.

### Benefits:

Fingertip control and a slim yet sturdy aluminium frame help this blind to lend an air of luxury to any environment and makes the C25 a perfect choice for motorised requirements. Its quiet and reliable motor is housed within the barrel and supported by sturdy, metal brackets.

### Options:

Black or white hardware; Remote and/or group control systems in place of single switch; With side channels C45-60/90. Wire side-guiding system; Available in any RAL colour.

### Specification:

C25-60/90 low voltage electric cassetted blind. Flame retardant fabric from the range, locked into grooved 40mm aluminium barrel along with aluminium bottom bar as standard. Low voltage 24v DC motor is housed within black/white aluminium cassette.

Please refer to NBS Plus N10 240.

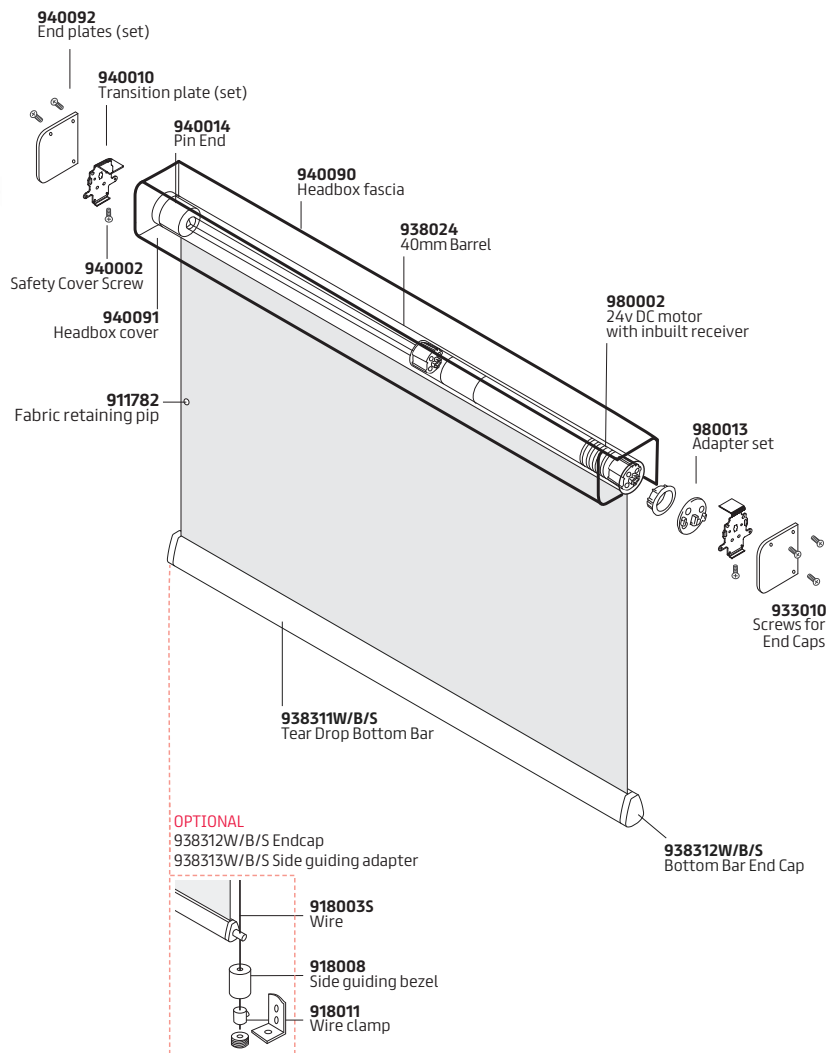

## Cassetted Blind Profile Dimension Guide

Model	Cassette Size (HxD)	Barrel Size Ø	Side Channel Size (WxD)
C25-60	77 x 73mm	40mm	n/a
C25-90	105 x 95mm	40mm	n/a



## C27 Electric 230v

### Features:

The C27 electric cassetted blind features a 230v AC motor as standard. Cassette is designed for top or face fixing and accommodates 40mm grooved aluminium barrel, housing the motor. The motor is controlled by a switch which may be surface or flush mounted (not supplied as standard). Fabric is locked into groove in barrel and an aluminium bottom bar. Black or white hardware as standard.

### Benefits:

The C27 offers a premium electric operated cassetted blind for situations where durability and functionality are required. Its quiet and reliable motor is housed within the barrel and further protected by the robust aluminium head-box housing. The fabric is locked into the barrel and bottom bar and will give years of trouble-free use. It is located in the groove so that it may be slid out sideways for easy repair or replacement of blind cover.

### Options:

Black or white hardware; Remote and/or group control systems in place of single switch; With side channels C47-90/120; Wire side-guiding system; Available in any RAL colour.

### Specification:

C27-90/120 electric cassetted blind. Flame retardant fabric from the range, locked into grooved 53/70mm aluminium barrel along with aluminium bottom bar as standard. 230v AC motor is housed within black/white aluminium cassette.

Please refer to NBS Plus N10 240.

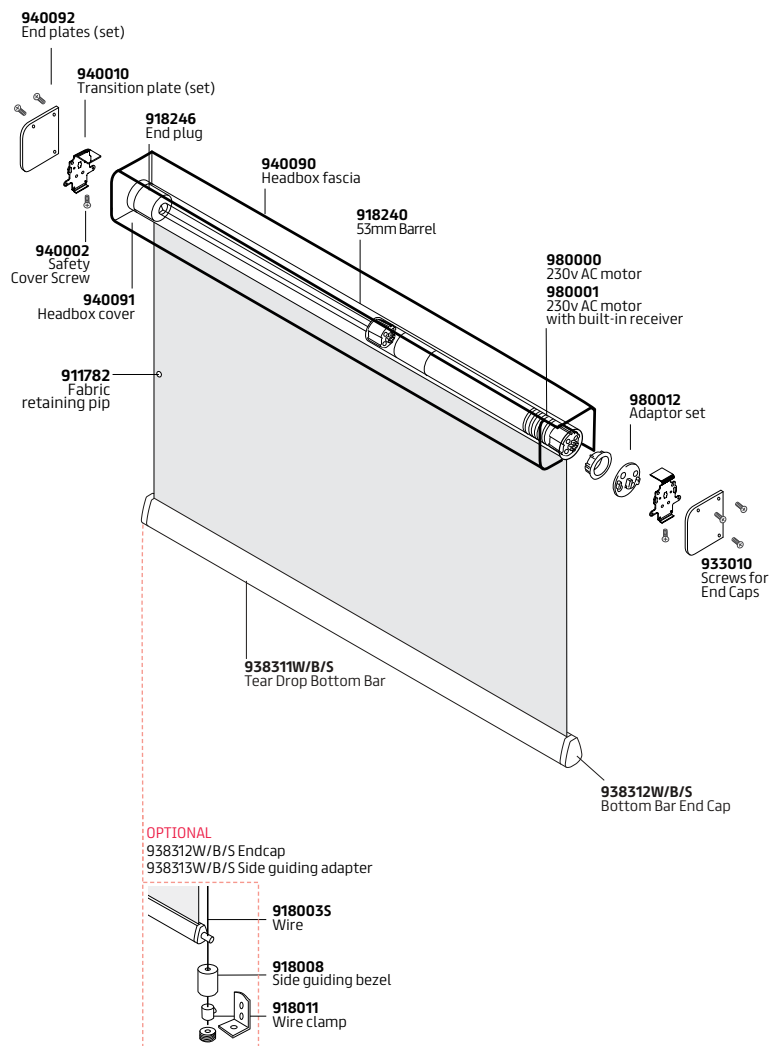

## Cassetted Blind Profile Dimension Guide

Model	Cassette Size (HxD)	Barrel Size Ø	Side Channel Size (WxD)
C27-90	105 x 95mm	53mm	n/a
C27-120	140 x 120mm	53 / 70mm	n/a

# Cassette Blinds



## C40 Sidewinder

### Features:

All of the C40 sidewinder cassetted blinds come with an enclosed aluminium head-box and side channels as standard. The cassette is designed for top or face fixing and accommodates 32, 45, 53 or 70mm grooved aluminium barrels, depending on blind size and fabric weight. Fabric is locked into groove in barrel, and features aluminium bottom bar with pile seal. A robust Slipstream® sidewinder mechanism provides the effective means of operation with the use of metal control chain, held in place by a chain tidy. Studs fitted at edge of fabric to retain it within side channels. Black or white hardware as standard.

### Benefits:

The excellent performance of a cassetted blind is further enhanced by the addition of side channels, giving positive and consistent location of the fabric and bottom bar, and provides light exclusion if blackout fabric is used. The entire range is offered as an aesthetically pleasing solution, protecting the fabric in the process. The quality sidewinder mechanisms are simple to operate and allow accurate control of blind position.

### Options:

Black or white hardware; Without side channels, C20-60/90/120; Tracker fabric retaining system; Available in any RAL colour.

### Specification:

C40-60/90/120 cassetted blind with side channels. Flame retardant fabric from the range, locked into grooved 32/45/53/70mm aluminium barrel along with aluminium bottom bar as standard. Black/white aluminium cassette, side channels and bottom bar and incorporating metal control chain.

Please refer to NBS Plus N10 240.

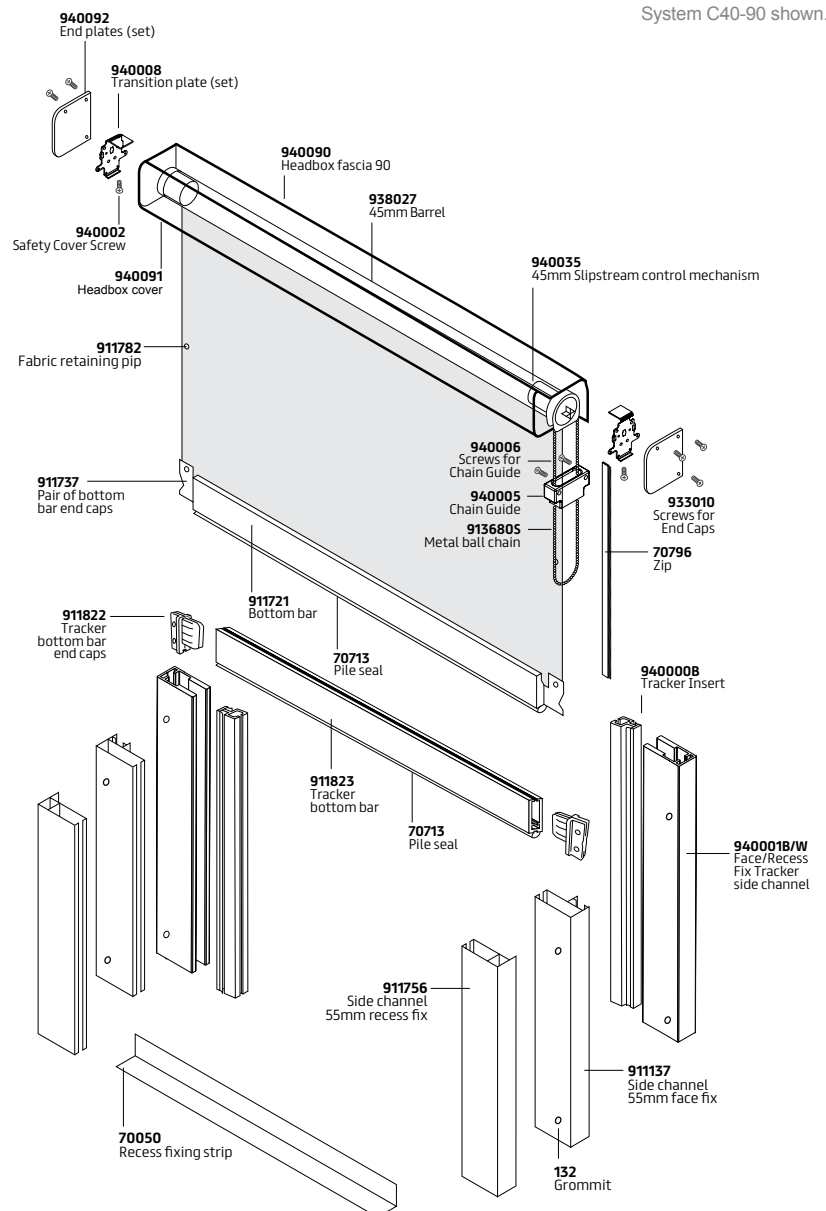

## Cassette Blind Profile Dimension Guide

Model	Cassette Size (HxD)	Barrel Size Ø	Side Channel Size (WxD)
C40-60	77 x 73mm	32mm	55 x 13mm
C40-90	105 x 95mm	45mm	55 x 13mm
C40-120	140 x 120mm	53 / 70mm	55 x 13mm



## C42 Braked Spring

### Features:

The C42 cassetted braked spring roller blind with premium quality spring and decelerator ensures smooth and quiet operation. Direct fix for top and face applications. Fabric is locked into a groove in the 32mm aluminium barrel, and features aluminium bottom bar with handle and a plastic cleat to hold the blind closed. Studs fitted at edge of fabric to retain it within side channels. Black or white hardware as standard.

### Benefits:

An attractive metal-framed blind with the added appeal of slow-rise, or braked, technology. It is generally used to reduce levels of light in a room, or as an insect screen as it has no mid-point stopping positions. The braked spring and decelerator mechanism is enclosed within the barrel.

### Options:

Black or white hardware available in any RAL colour.

### Specification:

C42-60 braked spring control cassetted blind with side channels. Flame retardant fabric from the range, locked into grooved 32mm aluminium barrel along with aluminium bottom bar as standard and plastic cleat to hold the blind closed. Vandal resistant braked spring and spring end housed within black/white aluminium cassette with side channels and bottom bar.

Please refer to NBS Plus N10 240.

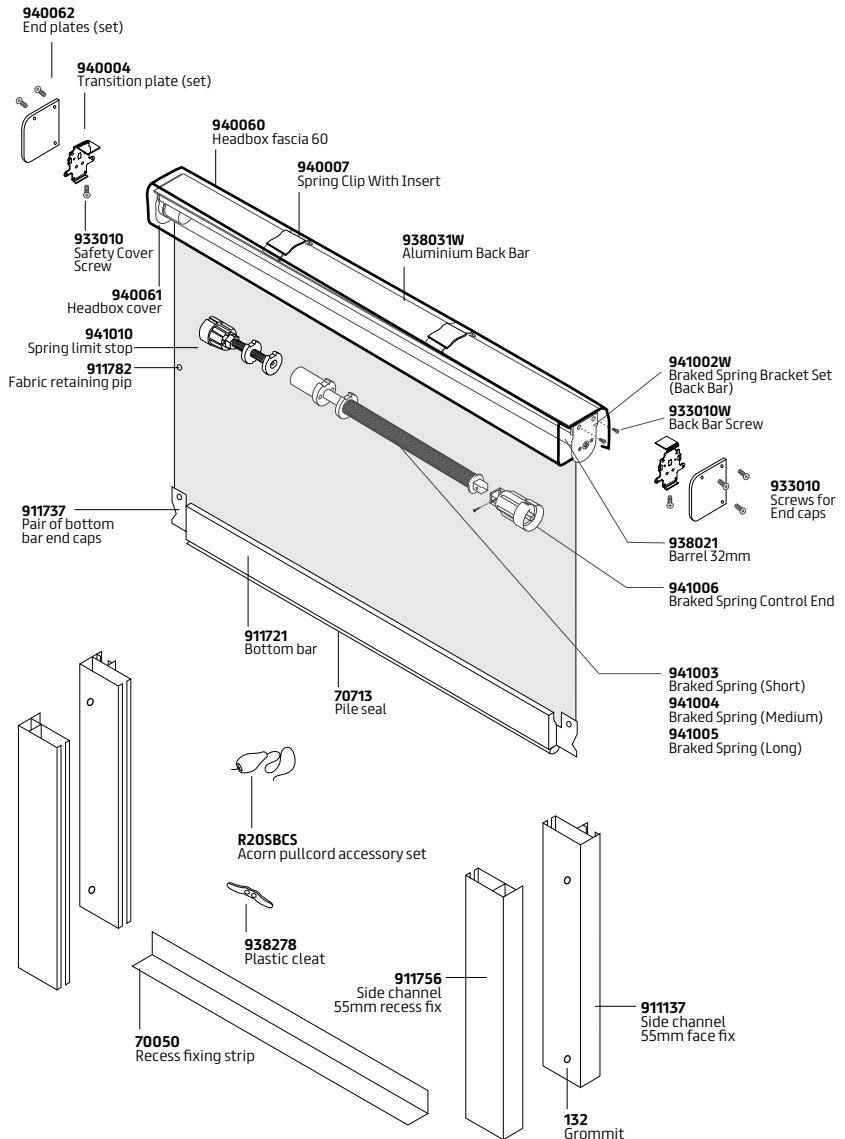

## Cassetted Blind Profile Dimension Guide

Model	Cassette Size (HxD)	Barrel Size Ø	Side Channel Size (WxD)
C42-60	77 x 73mm	32mm	55 x 13mm

# Cassetted Blinds



## C44 Crank

### Features:

The C44 crank control cassetted blind features a compact, robust 1:3½ gear mechanism operated by a detachable crank handle. The cassette is designed for top or face fixing and accommodates 45, 53 or 70mm grooved aluminium barrels, depending on blind size and fabric weight. The fabric is locked into a groove in the barrel with studs fitted at the edge of fabric to retain it within side channels. Aluminium bottom bar. Black or white hardware as standard.

### Benefits:

Durability and simplicity make the C44 a good choice for a vast range of applications. With its aluminium side channels and powerful gear controls it will perform dependably in all kinds of contract applications. The geared crank handle and mechanism ensures smooth blind control and is safer for areas where cords are a threat. Fabric locked into the barrel and bottom bar and supported by sturdy supports.

### Options:

Black or white hardware; Fixed crank handle; Tracker fabric retaining system; Available in any RAL colour.

### Specification:

The C44-90/120 crank control cassetted blind with side channels. Flame retardant fabric from the range, locked into grooved 45/53/70mm aluminium barrel along with aluminium bottom bar as standard. Robust vandal resistant 1:3½ crank mechanism and pin end housed within black/white aluminium cassette with side channels and bottom bar.

Please refer to NBS Plus N10 240.

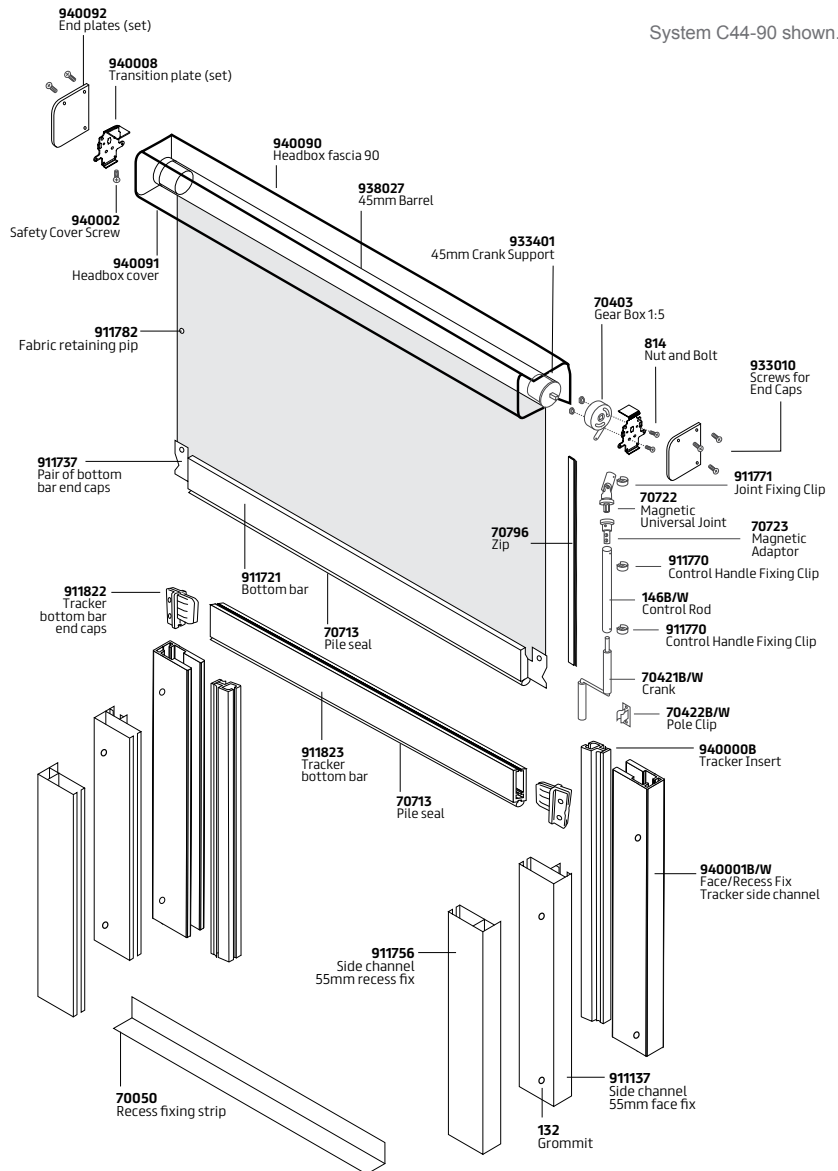

System C44-90 shown.

## Cassetted Blind Profile Dimension Guide

Model	Cassette Size (HxD)	Barrel Size Ø	Side Channel Size (WxD)
C44-90	105 x 95mm	45mm	55 x 13mm
C44-120	140 x 120mm	53 / 70mm	55 x 13mm



## C45 Electric 24v

### Features:

The C45 electric cassetted blind with side channels features a low voltage 24v DC motor as standard. The cassette is designed for top or face fixing and accommodates a 40mm grooved aluminium barrel, housing the 24v DC motor. The motor is controlled by a switch which may be surface or flush mounted (not supplied as standard). Fabric is locked into a groove in the barrel with studs fitted at the edge of fabric to retain it within side channels. Aluminium bottom bar. Black or white hardware as standard.

### Benefits:

Fingertip control and a slim yet sturdy aluminium frame help this blind lend an air of luxury to any environment and makes the C45 a perfect choice for motorised requirements. Its quiet and reliable motor is housed within the barrel and supported by sturdy, metal brackets.

### Options:

Black or white hardware; Remote and/or group control systems in place of single switch; Tracker fabric retaining system; Available in any RAL colour.

### Specification:

The C45-60/90 low voltage electric cassetted blind with side channels. Flame retardant fabric from the range, locked into grooved 40mm aluminium barrel along with aluminium bottom bar as standard. Low voltage 24v DC motor is housed within black/white aluminium cassette with side channels and bottom bar.

Please refer to NBS Plus N10 240.

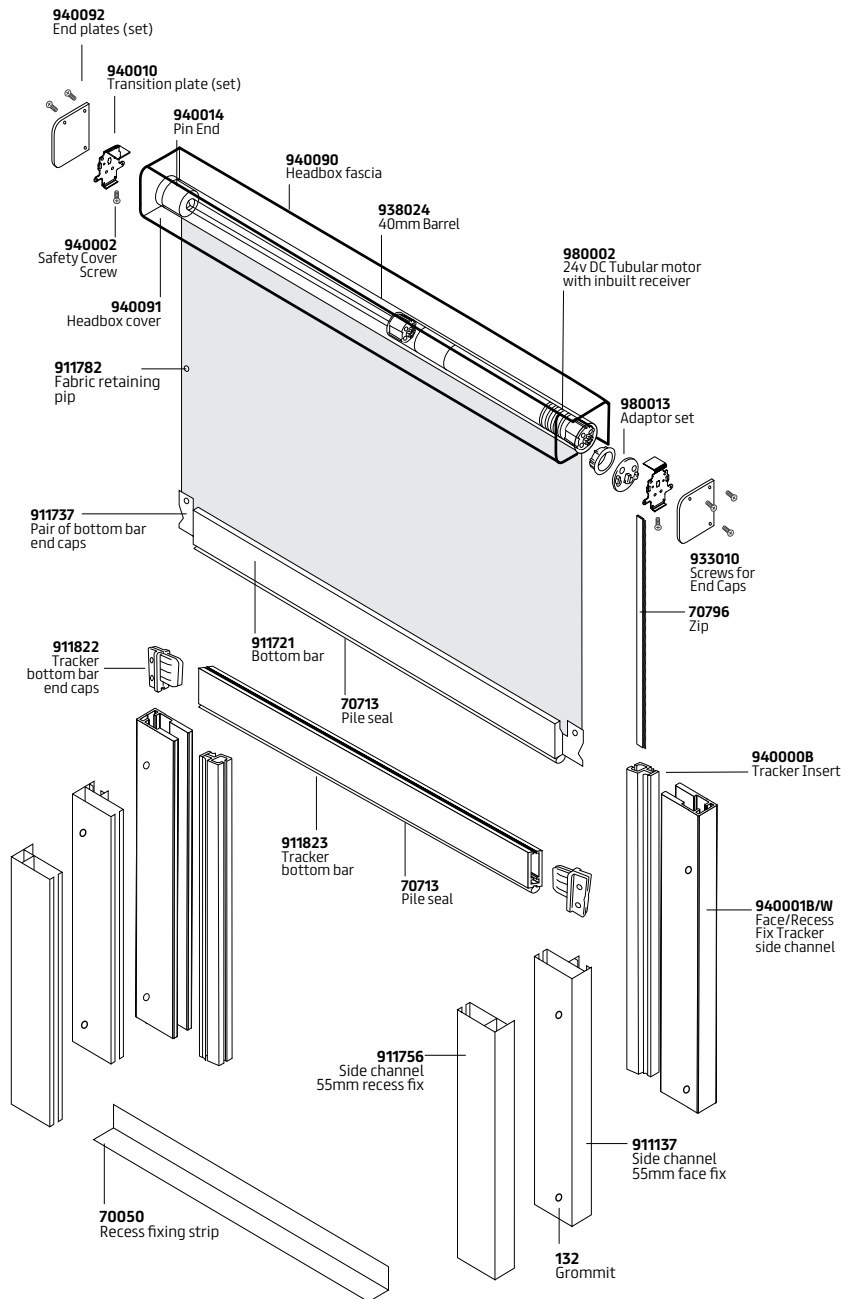

## Cassetted Blind Profile Dimension Guide

Model	Cassette Size (HxD)	Barrel Size Ø	Side Channel Size (WxD)
C45-60	77 x 73mm	40mm	55 x 13mm
C45-90	105 x 95mm	40mm	55 x 13mm



# Cassetted Blinds



## C47 Electric 230v

### Features:

The C47 electric cassetted blind with side channels features a motor as standard. The cassette is designed for top or face fix and accommodates a 40mm grooved aluminium barrel, housing the 230v AC motor. The motor is controlled by a switch which may be surface or flush mounted (not supplied as standard). Fabric is locked into a groove in the barrel with studs fitted at the edge of the fabric to retain it within the side channels. Aluminium bottom bar. Black or white hardware as standard.

### Benefits:

The C47 offers a premium electric operated cassetted blind for situations where durability and functionality are required. Its quiet and reliable motor is housed within the barrel and further protected by the robust aluminium head-box housing. The fabric is locked into the barrel and bottom bar and will give years of trouble-free use. It is located in the groove so that it may be slid out sideways for easy repair or replacement of blind cover.

### Options:

Black or white hardware; Remote and/or group control systems in place of single switch; Tracker fabric retaining system; Available in any RAL colour.

### Specification:

The C47-90/120 electric cassetted blind with side channels. Flame retardant fabric from the range, locked into grooved 53/70mm aluminium barrel along with aluminium bottom bar as standard. 230v AC motor is housed within black/white aluminium cassette with side channels and bottom bar.

Please refer to NBS Plus N10 240.

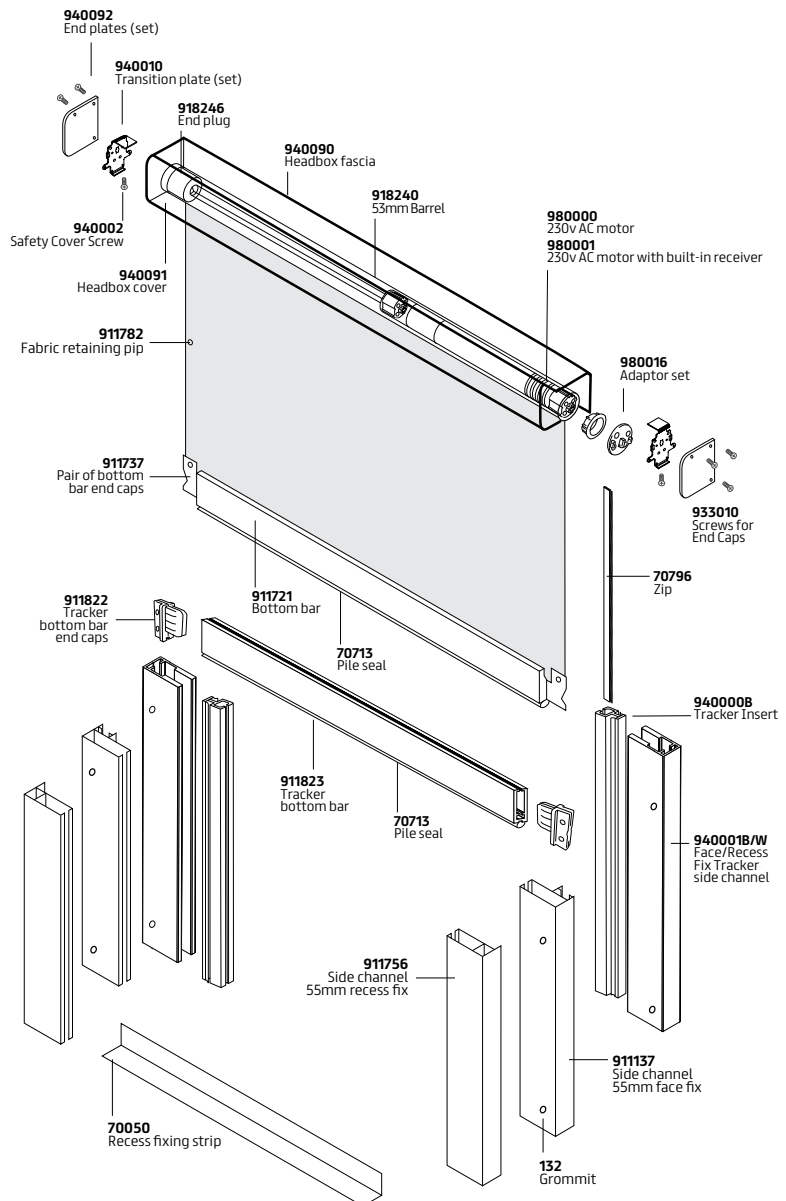

## Cassetted Blind Profile Dimension Guide

Model	Cassette Size (HxD)	Barrel Size Ø	Side Channel Size (WxD)
C47-90	105 x 95mm	53mm	55 x 13mm
C47-120	140 x 120mm	53 / 70mm	55 x 13mm



# Overhead Cassetted Blinds



## C56T Overhead Crank

### Features:

Smooth operation and complete control is what makes the C56T overhead cassetted blind so inspiring. The 1:5 gear control crank mechanism allows you to easily operate the blind, and the fabric is held in place in the side channels. This blind is drawn across the window by tensioned spring units on the bottom bar and the powder-coated aluminium headbox is slim and discreet, making it ideal for buildings looking for a stylish overhead blind. The C56T can be made to a maximum size of 3m X 3m.

### Benefits:

The C56T overhead cassetted blind is a diverse, bracketless shading solution that provides control over the amount of light entering a large overhead window. However, unlike other overhead blinds, this solution is discreet. The headbox and sidechannels are slim and available in black or white powder-coated aluminium, and operation is quiet and smooth and the fabric is held tight across the blind, eliminating sagging. The robust, detachable crank and vandal resistant 1:5 gear control crank mechanism makes this blind ideal for a multitude of contract applications.

### Options:

Black or white hardware, fixed crank. It is recommended that only the following fabrics are used in conjunction with this product: Medway, Roach, Roe.

### Specification:

The C56-90/120T overhead cassetted blind with Tracker Fabric Retaining System and crank control. Flame retardant fabric from the range, on a grooved 53/70mm aluminium barrel along with aluminium bottom bar as standard. The barrel, driven by a vandal resistant 1:5 gear control crank mechanism, operates the blind by means of tensioned spring units connected to the bottom bar. Twin black/white powder-coated aluminium headbox cassettes, side and bottom channels and bottom bar and incorporating a detachable crank handle.

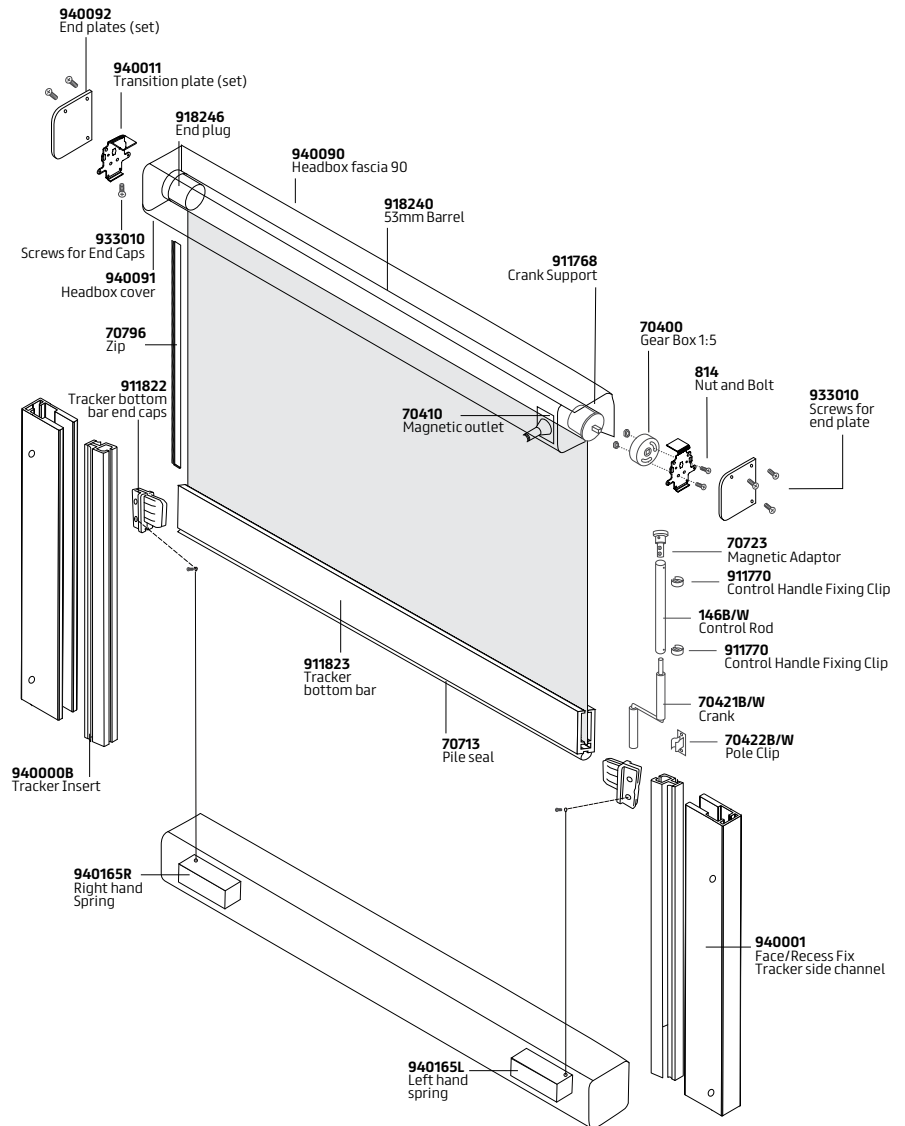

## Cassetted Blind Profile Dimension Guide

Model	Cassette Size (HxD)	Barrel Size Ø	Side Channel Size (WxD)
C56-90T	105 x 95mm	53mm	50 x 24.8mm
C56-120T	140 x 120mm	53 / 70mm	50 x 24.8mm



## C57T Overhead Electric

### Features:

The C57T overhead cassetted blind has a remote control to operate it, making the possibilities for installation enormous. At the touch of a button your 230v AC Tubular Motor with radio receiver will operate the blind. This blind is quietly drawn across the window by tensioned spring units on the bottom bar, with the fabric held in place and prevented from dropping by the side channels. The powder-coated aluminium headbox provides a discreet and stylish solution of overhead shading. The C57T can be made to a maximum size of 3m X 3m.

### Benefits:

The C57T provides absolute control over the blind at the touch of a button due to the single channel hand held transmitter, making this blind easy to operate in otherwise difficult areas. The discreet and slim powder-coated aluminium headbox allows the blind to blend in with the interior design of the room whilst providing the shading solution required. This blind is bracket less which eliminates room for light-seepage and is simpler to install in comparison to other overhead blinds.

### Options:

Black or white hardware, hard-wired or RTS motor. It is recommended that only the following fabrics are used in conjunction with this product: Medway, Roach, Roe.

### Specification:

The C57-90/120T electric overhead cassetted blind with Tracker Fabric Retaining System. Flame retardant fabric from the range, on a grooved 53/70mm aluminium barrel along with aluminium bottom bar as standard. The barrel, driven by a 230v AC motor, operates the blind by means of tensioned spring units connected to the bottom bar. Twin black/white powder-coated aluminium headbox cassettes, side and bottom channels and bottom bar.

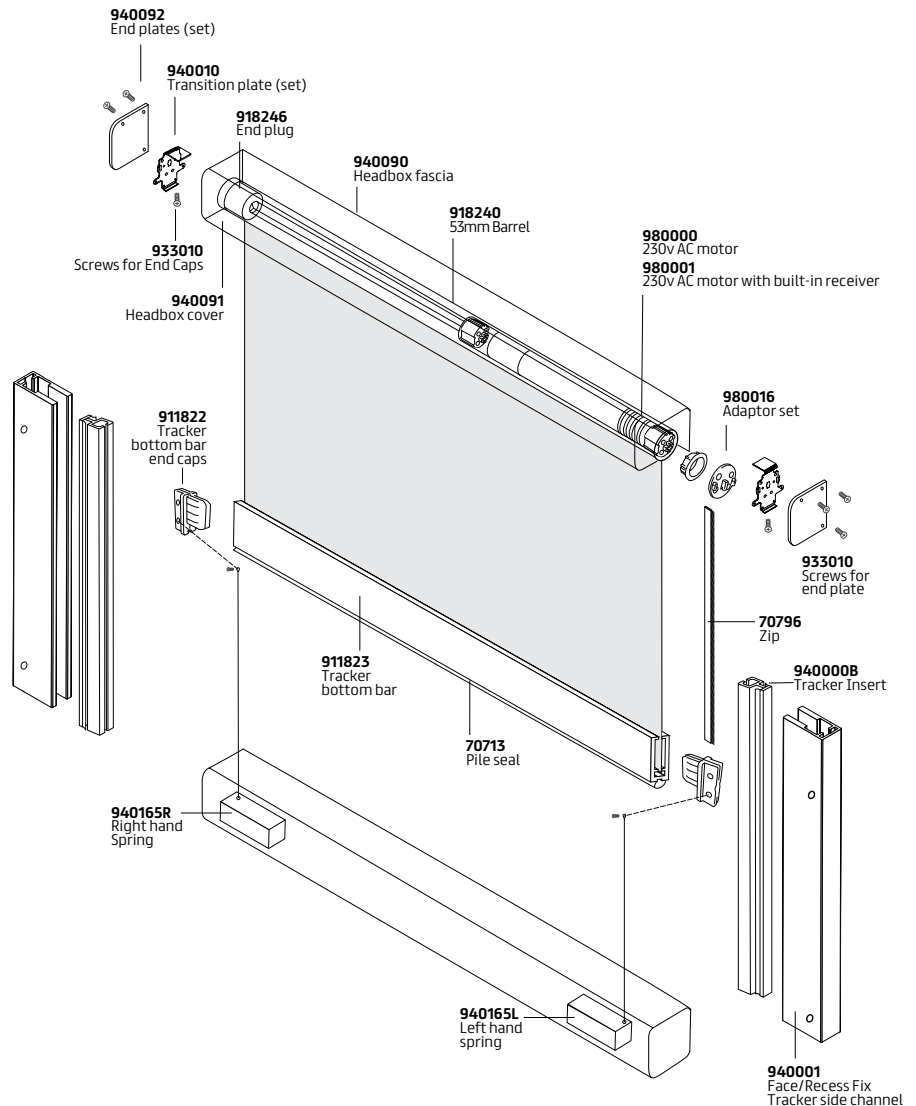

## Cassetted Blind Profile Dimension Guide

Model	Cassette Size (HxD)	Barrel Size Ø	Side Channel Size (WxD)
C57-90T	105 x 95mm	53mm	50 x 24.8mm
C57-120T	140 x 120mm	53 / 70mm	50 x 24.8mm

# Cassetted Blinds



## Laser Blinds For Operating Theatres

### Features:

The Laser Material provides protection from stray laser radiation and is available on a full spectrum of roller blinds. Designed to be used as passive guards in all areas where Class 3B or Class 4 lasers are regularly in use. The material is certified to EN 60824 -4 (Safety of Laser Products Part 4: Laser Guards) and is fire proof.

### Benefits:

Available on a full range of roller blind systems to ensure there is a solution to virtually all laser blocking requirements. All blinds are made to measure. Recommended systems are detailed below: R20; R20C; R40; R55; VPF; C74; C75.

### Options:

Laser fabric available in black; Suitable for chain, crank, and electric operation; Suitable for vision panel flaps.

### Specification:

Laser Material products for protection from stray laser radiation. Flame retardant fabric from laser fabric range, certified to EN60824-4 (Safety of Laser Products Part 4: Laser Guards).

Please refer to NBS Plus N10 240.

## Tracker Fabric Retaining System

### Features:

The unique Tracker Fabric Retaining System guarantees 100% fabric fastness and completely eradicates the common call-out problems of 'fabric blowing/been pushed out of the side channel'. The channel measures 50 x 24.8mm and is available in black or white hardware. Suitable for the C40/C44/C45, C47, C56T and C57T, the Tracker side channel will cater for both recess and face fix applications. Clever flexible plastic seals maintain constant fabric tension.

### Benefits:

The excellent performance characteristics of this unique side channel coupled with its ease of use means that it works with nearly all of the range of cassetted blinds. It is both popular and ideal for areas such as schools, colleges, universities and hospitals. The unique channel will cater for uneven reveals and provides maximum light exclusion.

### Options:

Available in black or white hardware.

### Specification:

C40T-60/90/120, C44T-90/120, C45T-60/90, C47T-90/120, C56/C57T cassetted blind with Tracker Fabric Retaining System. Flame retardant fabric from the range, locked into grooved 32/40/45/53mm aluminium barrel along with aluminium bottom bar as standard. Black/white aluminium cassette, side channels and bottom bar are supported by sturdy brackets. Control options as directed.

Please refer to NBS Plus N10 240.



## Cassetted Blind Specification Guide

Cassetted blinds		Min Width	Max Width	Max Drop	Max m <sup>2</sup>
C20-60	Sidewinder 60mm Cassette	200	2050	2150	3.5
C20-90	Sidewinder 90mm Cassette	200	3450	4250	6.5
C20-120	Sidewinder 120mm Cassette	200	4700	5750	11.5
C22-60	Braked Spring 60mm Cassette	450	1850	2450	4.3
C24-90	Crank 90mm Cassette	200	3450	4250	6.5
C24-120	Crank 120mm Cassette	200	4700	5750	10.0
C25-60	Electric 24v 60mm Cassette	500	2650	2350	7.0
C25-90	Electric 24v 90mm Cassette	500	2650	3350	7.0
C27-90	Electric 230v 90mm Cassette	570	3450	3450	10.0
C27-120	Electric 230v 120mm Cassette	570	4700	5750	11.5

Based on fabric weight of 400g/m<sup>2</sup>, e.g. Dart. Larger sizes may be possible with lighter/thinner fabrics.

Cassetted blinds with side channels		Min Width	Max Width	Max Drop	Max m <sup>2</sup>
C40-60	Sidewinder 60mm Cassette with Side Channels	200	2050	2000	3.5
C40-90	Sidewinder 90mm Cassette with Side Channels	200	3450	3250	6.5
C40-120	Sidewinder 120mm Cassette with Side Channels	200	4700	5000	11.5
C42-60	Braked Spring 60mm Cassette with Side Channels	500	1850	2000	3.7
C44-90	Crank 90mm Cassette with Side Channels	200	3450	3250	5.5
C44-120	Crank 120mm Cassette with Side Channels	200	4700	5000	10.0
C45-60	Electric 24v 60mm Cassette with Side Channels	500	2650	1500	3.9
C45-90	Electric 24v 90mm Cassette with Side Channels	500	2650	2000	6.6
C47-90	Electric 230v 90mm Cassette with Side Channels	570	3450	2450	9.0
C47-120	Electric 230v 120mm Cassette with Side Channels	570	4700	5000	11.5

Based on fabric weight of 400g/m<sup>2</sup>, e.g. Dart. Larger sizes may be possible with lighter/thinner fabrics.

Cassetted blinds with tracker side channels		Min Width	Max Width	Max Drop	Max m <sup>2</sup>
C40-60T	Sidewinder 60mm Cassette with Tracker Side Channels	200	1000	1500	1.5
C40-90T	Sidewinder 90mm Cassette with Tracker Side Channels	200	2000	2000	3.0
C40-120T	Sidewinder 120mm Cassette with Tracker Side Channels	200	3450	3450	10.5
C44-90T	Crank 90mm Cassette with Tracker Side Channels	200	3450	2850	5.5
C44-120T	Crank 120mm Cassette with Tracker Side Channels	200	3450	3450	9.0
C45-60T	Electric 24v 60mm Cassette with Tracker Side Channels	500	2650	1000	2.65
C45-90T	Electric 24v 90mm Cassette with Tracker Side Channels	500	2650	2000	5.3
C47-90T	Electric 230v 90mm Cassette with Tracker Side Channels	570	3450	2450	8.45
C47-120T	Electric 230v 120mm Cassette with Tracker Side Channels	570	3450	3450	10.0

Based on fabric weight of 400g/m<sup>2</sup>, e.g. Dart. Larger sizes may be possible with lighter/thinner fabrics.

Cassetted blinds with tracker side channels		Min Width	Max Width	Max Drop	Max m <sup>2</sup>
C56-90T	Crank 90mm Overhead Cassette with Tracker Side Channels	600	2400	3000	7.2
C56-120T	Crank 120mm Overhead Cassette with Tracker Side Channels	600	3000	3600	10.8
C57-90T	Electric 230v 90mm Overhead Cassette with Tracker Side Channels	800	2400	3000	7.2
C57-120T	Electric 230v 120mm Overhead Cassette with Tracker Side Channels	800	3000	3600	10.8

Based on fabric weight of 400g/m<sup>2</sup>, e.g. Dart. Larger sizes may be possible with lighter/thinner fabrics.



## Blackout Units

All blinds are carefully built to exacting standards, giving years of trouble-free service. The superior design features and quality components enable them to be confidently specified for the most demanding environments.

The full range is distributed globally through a network of partners providing an unrivalled level of support, and with experienced installation and service teams to exceed your expectations.

<b>C74 Crank Blackout</b>	<b>37</b>
<b>C75 Electric Blackout</b>	<b>38</b>
<b>C76 Overhead Crank Blackout</b>	<b>39</b>
<b>C77 Overhead Electric Blackout</b>	<b>40</b>
<b>Specification Guide</b>	<b>41</b>

Many blinds feature vandal-resistant controls and mechanisms, and are frequently seen in hospitals, schools, colleges and other public buildings, as well as the regular commercial and residential environments.

Blackout units offer you the ultimate in light exclusion providing exceptional performance of 100% light block where such criteria is a minimum requirement. Incorporating pile seals, light-transfer baffles and a positive consistent fabric tension, the C7 range is the blackout system of choice for many contract applications. You can find them regularly in use in operating theatres, drama studios, school halls, home cinemas and the like.



this blackout unit range comes with a Full Lifetime Warranty as standard.







## C74 Crank Blackout

### Features:

The C74 crank control blackout unit features a heavy duty 1:5 gear mechanism operated by a magnetic detachable crank handle. All hardware in black powder-coated aluminium, with moulded black plastic fittings, for face or recess fixing and encloses 53mm grooved aluminium barrel. Heavy-duty gear mechanism at right, controlled by fixed crank handle. Blackout fabric, with heavy-duty bottom bar, is locked into a groove in the barrel and runs in 75mm side channels. Slim bottom channel makes for positive attachment to side channels. Light-transfer baffles within side and bottom channels, and side channels and head-box fitted with pile-seal light sealing.

### Benefits:

The C74 is the blackout unit of choice for many contract applications. Offering 100% blackout properties, it is simple to operate and very strong, covering large windows with ease. It is in use in many schools and hospitals where dependability is an essential requirement, but its sleek good looks are at home wherever high performance light exclusion is called for.

### Options:

White hardware; No bottom channel, with bottom bar running down to sill; Fixed crank handle; Available in any RAL colour.

### Specification:

The C74 crank control 100% blackout unit with magnetic detachable crank handle. Flame retardant blackout fabric from the range, locked into grooved 53mm aluminium barrel along with aluminium bottom rail as standard. Heavy duty 1:5 geared crank mechanism is housed within black/white powder-coated aluminium head-box cassette, side and bottom channels and bottom bar supported by sturdy brackets.

Please refer to NBS Plus N10 240.

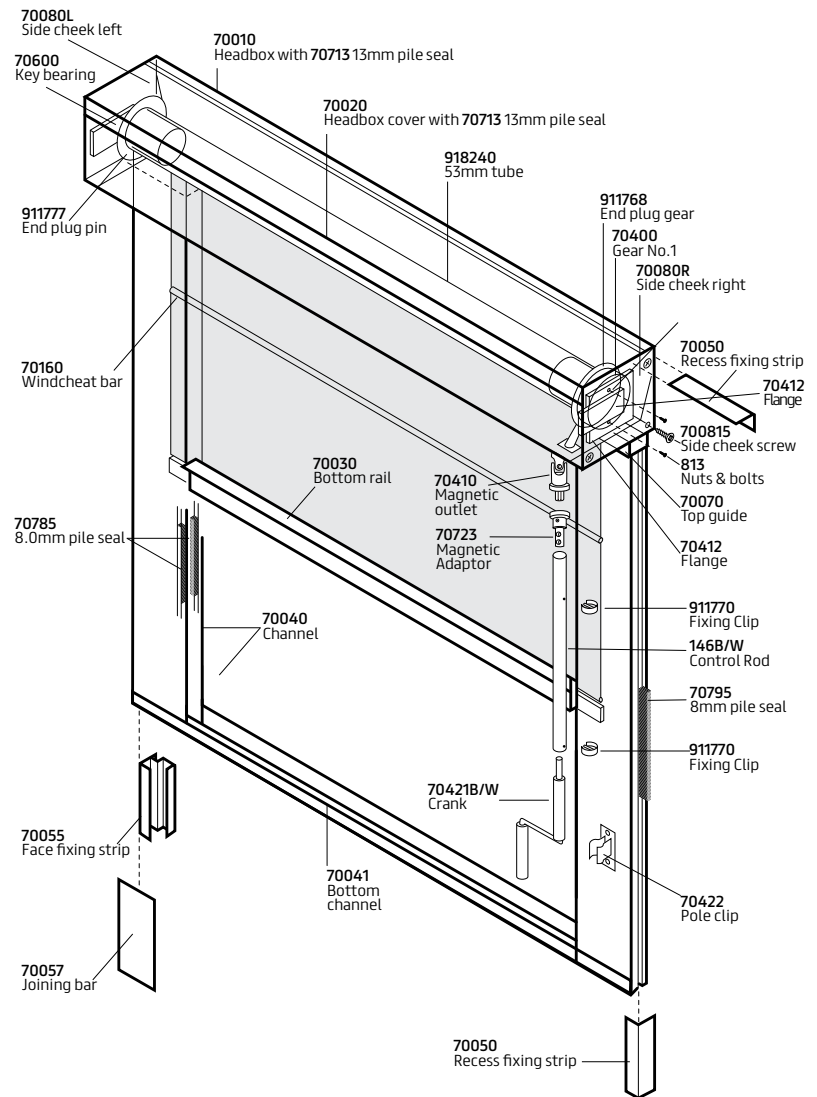

## Blackout Unit Profile Dimension Guide

Model	Cassette Size (HxD)	Barrel Size Ø	Side Channel Size (WxD)	Side cheek
C74	100 x 100mm	53mm	75 x 20mm	Metal

# Blackout Units



## C75 Electric Blackout

### Features:

The C75 electric blackout unit features a 230v AC motor as standard. All hardware in black powder-coated aluminium, with moulded black plastic fittings, for face or recess fixing and encloses 53mm grooved aluminium barrel, controlled by 230v AC motor. Blackout fabric, with heavy-duty bottom bar, is locked into a groove in the barrel and runs in 75mm side channels. Slim bottom channel for positive attachment to side channels. Light-transfer baffles within side and bottom channels, and side channels and head-box fitted with pileseal light sealing. The motor is controlled by a switch/transformer which may be surface or flush mounted (not supplied as standard).

### Benefits:

The C75 is a premium 100% blackout unit with the luxury of fingertip electrical control. Its quiet and reliable motor is housed within the barrel and supported by sturdy, aluminium cassette system. With the RF or infrared remote, and/or group control option, almost any control configuration can be achieved.

### Options:

White hardware; No bottom channel, with bottom bar running down to sill; Remote and/or group control systems; Available in any RAL colour.

### Specification:

The C75 electric 100% blackout unit with 230v AC motor. Flame retardant blackout fabric from the range, locked into grooved 53mm aluminium barrel along with aluminium bottom rail as standard. 230v AC motor housed within black/white powder-coated aluminium head-box cassette with side and bottom channels and bottom bar.

Please refer to NBS Plus N10 240.

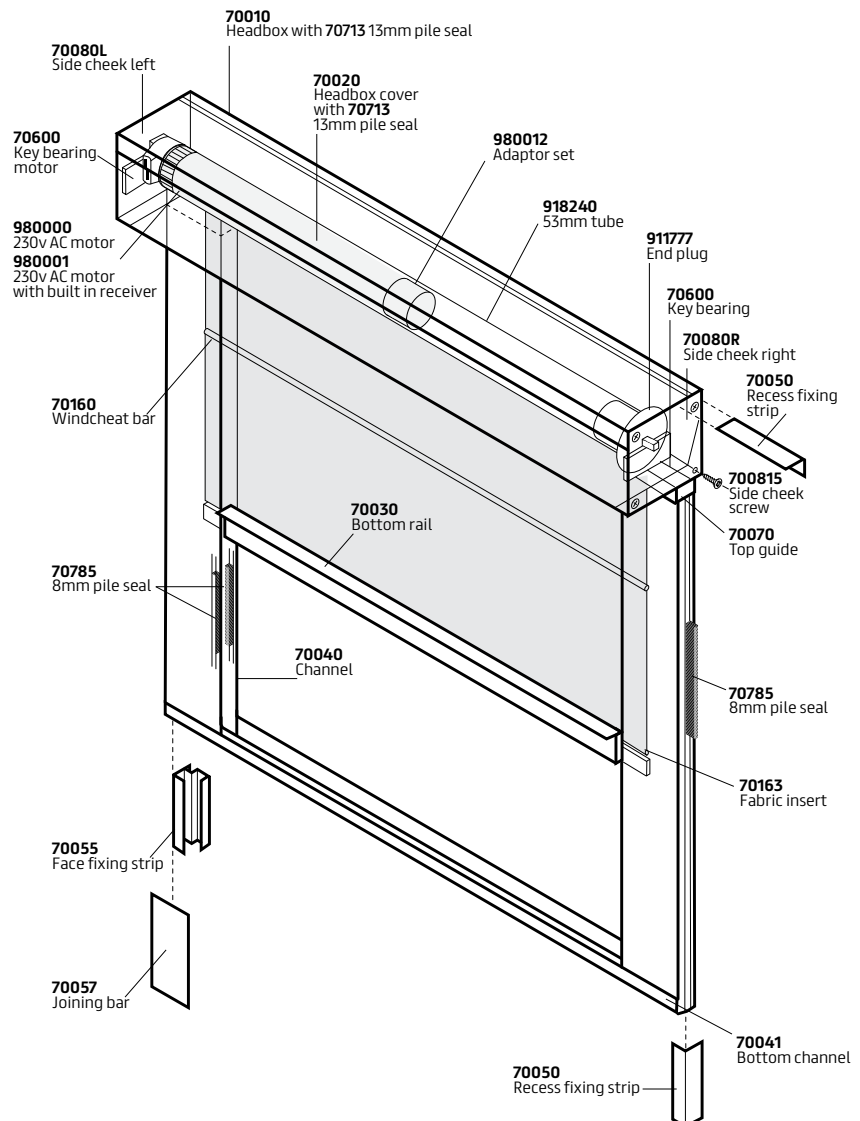

## Blackout Unit Profile Dimension Guide

Model	Cassette Size (HxD)	Barrel Size Ø	Side Channel Size (WxD)	Side cheek
C75	100 x 100mm	53mm	75 x 20mm	Metal



The C76 crank operation overhead blackout unit's hardware is black powder-coated aluminium for face or recess fixing. Enclosed are 53mm and 57mm grooved aluminium barrels. Blackout fabric is locked into a groove in the barrel and runs in 75mm side channels. Light-transfer baffles are located within the side and bottom channels, and the side channels and head-box is fitted with pile-seal light sealing. Fabric is mounted onto a sprung 57mm aluminium barrel whilst at the other end is fitted to an aluminium bottom rail, attached to two draw tapes. These tapes are attached, between flanged guides, to the 53mm drive barrel, operated by heavy duty 1:5 gear control mechanism and magnetic detachable crank handle.

The C76 blackout unit is the ultimate in choice for 100% light exclusion requirements for sloping or horizontal roof windows. With heavy duty componentry and tensioning action by powerful spring to the fabric roller, these blinds may be confidently specified for awkward or inaccessible locations. The magnetic detachable crank handle removes the common issues associated with locating the drive at height and solves the problem of unauthorised use.

White hardware; Fixed crank handle; Available in any RAL colour.

The C76 crank overhead blackout unit with 1:5 geared crank. Flame retardant blackout fabric from the range, on 57mm aluminium barrel with enclosed spring attached to aluminium bottom rail as standard. 53mm drive barrel connected to gear control crank mechanism operates blind by means of draw-tapes to the bottom bar. Black/white powder-coated aluminium headbox cassettes, side and bottom channels and bottom bar. Incorporating detachable crank handle.

70421B/W Crank

911770 Fixing Clip

146B/W Control Rod

70723 Magnetic Adaptor

70722 Magnetic Universal Joint

70505 End plug support

70080B/W Side cheek

70600 Key bearing

70010B/W Headbox with 70713 13mm pile seal

70020B/W Headbox cover with 70713 13mm pile seal

918241 50mm tube

70502 Flange ring

70501 End plug gear

70400 Gear No.1

70080B/W Side cheek

70050B/W Recess fixing strip

700815B/W Side cheek screw

813 Nuts & bolts

70070B/W Top guide

70412 Flange

70170 Draw tape

70503 Split pin

70795 9.5mm pile seal

Blackout fabric

70070B/W Top guide

70080B/W Side cheek

700815B/W Side cheek screw

70660 57mm barrel

70652 Spring long

70654 Spring short

70651 Dummy spindle

70650 Block

70010B/W Headbox with 70713 13mm pile seal

70020B/W Headbox cover with 70713 13mm pile seal

70600 Key bearing spring

70555B/W Face fixing strip

70705 Windcheat bar

70080B/W Side cheek

70120B/W Bottom rail reducer

70030 Bottom rail

70410 Magnetic outlet

70040 Channel

70785 8.5mm pile seal

70503 Split pin

70502 Flange ring

70020B/W Headbox cover with 70713 13mm pile seal

70010B/W Headbox with 70713 13mm pile seal

70600 Key bearing

70505 End plug support

70421B/W Crank

911770 Fixing Clip

146B/W Control Rod

70723 Magnetic Adaptor

70722 Magnetic Universal Joint

70501 End plug gear

70400 Gear No.1

70080B/W Side cheek

70050B/W Recess fixing strip

700815B/W Side cheek screw

813 Nuts & bolts

70070B/W Top guide

70412 Flange

70170 Draw tape

70503 Split pin

70795 9.5mm pile seal

Blackout fabric

70070B/W Top guide

70080B/W Side cheek

700815B/W Side cheek screw

70660 57mm barrel

70652 Spring long

70654 Spring short

70651 Dummy spindle

70650 Block

70010B/W Headbox with 70713 13mm pile seal

70020B/W Headbox cover with 70713 13mm pile seal

70600 Key bearing spring

70555B/W Face fixing strip

70705 Windcheat bar

70080B/W Side cheek

70120B/W Bottom rail reducer

70030 Bottom rail

70410 Magnetic outlet

70040 Channel

70785 8.5mm pile seal

70503 Split pin

70502 Flange ring

## Blackout Unit Profile Dimension Guide

Model	Cassette Size (HxD)	Barrel Size Ø	Side Channel Size (WxD)	Side cheek
C76	100 x 100mm	53 & 57mm	75 x 20mm	Metal

## Blackout Units



The C77 electric overhead blackout unit with a motor. All hardware in black powder-coated aluminium for face or recess fixing and enclosing 53mm and 57mm grooved aluminium barrels. Blackout fabric, with heavy duty bottom rail, is locked into a groove in the barrel and runs in 75mm side channels. Light-transfer baffles are within the side and bottom channels, and the side channels and head-box are fitted with pile-seal for light sealing. Fabric is mounted onto a sprung 57mm aluminium barrel whilst at the other end it is fitted to an aluminium bottom rail, attached to two draw tapes. These tapes are attached, between flanged guides, to the 53mm drive barrel, operated by a 240v AC motor.

The C77 blackout unit is the ultimate in choice for 100% light exclusion requirements for sloping or horizontal roof windows when an electrically operated solution is sought after. With heavy duty componentry and tensioning action by powerful spring to the fabric roller, these blinds may be confidently specified for awkward or inaccessible locations. The 230v AC motor, which provides the luxury of reliable electrical fingertip control, is housed within the barrel and supported by sturdy, aluminium cassette system.

White hardware; Remote and/or group control systems; Available in any RAL colour.

The C77 electric overhead blackout unit with 230v AC motor. Flame retardant blackout fabric from the range, on 57mm aluminium barrel with enclosed spring attached to aluminium bottom rail as standard. 53mm drive barrel connected to gear control crank mechanism operates blind by means of draw-tapes to the bottom bar. Black/white powder-coated aluminium headbox cassettes, side and bottom channels and bottom bar. Incorporating 230v AC motor.

Diagram illustrating the components of a window blind assembly, showing the exploded view of the headbox, slats, and bottom rail assembly.

**Headbox Components:**

- 700808/W Side cheek
- 70010 B/W Headbox with 70713 13mm pile seal
- 70020B/W Headbox cover with 70713 13mm pile seal
- 918241 50mm tube
- 70502 Flange ring
- 70505 End plug pin
- 700808/W Side cheek
- 70050B/W Recess fixing strip
- 700815B/W Side cheek screw
- 70070B/W Top guide
- 70500 Draw tape
- 70795 9.5mm pile seal
- 70503 Split pin
- 70070B/W Top guide
- 700808/W Side cheek
- 700815B/W Side cheek screw

**Slat Components:**

- 70600 Key bearing
- 70938 Motor adaptor wheel + crown
- 70040B/W Channel
- 70030B/W Bottom rail
- 70660 57mm barrel
- 70652 Spring long
- 70654 Spring short
- 70651 Dummy spindle
- 70650 Block
- 70010B/W Headbox with 70713 13mm pile seal
- 70020B/W Headbox cover with 70713 13mm pile seal
- 70600 Key bearing spring

**Bottom Rail Components:**

- 980000 230v AC motor
- 980001 230v AC motor with built in receiver
- 70502 Flange ring
- 70785 8.5mm pile seal
- 70503 Split pin
- 70120B/W Bottom rail reducer
- 70160 Windcheat bar
- 70080B/W Side cheek
- 70050B/W Recess fixing strip
- 70055B/W Face fixing strip

**Other Components:**

- 700808/W Side cheek
- 700815B/W Side cheek screw
- 70070B/W Top guide
- 70500 Draw tape
- 70795 9.5mm pile seal
- 70503 Split pin
- 70070B/W Top guide
- 700808/W Side cheek
- 700815B/W Side cheek screw

Model	Cassette Size (HxD)	Barrel Size Ø	Side Channel Size (WxD)	Side cheek
C77	100 x 100mm	53 & 57mm	75 x 20mm	Metal

## Blackout Unit Specification Guide

Blackout units	Min Width	Max Width	Max Drop	Max m <sup>2</sup>
C74 Crank Blackout Unit	200	3600	3600	9.0
C75 Electric 230v Blackout Unit	700	3600	3600	10.8
C76 Overhead Crank Blackout Unit	720	2000	2600	4.2
C77 Overhead Electric 230v Blackout Unit	720	2000	2600	4.2

Based on fabric weight of 400g/m<sup>2</sup>, e.g. Dart. Larger sizes may be possible with lighter/thinner fabrics.

## Insect Screens

All Insect Screens are carefully built to exacting standards, giving years of trouble-free service. The superior design features and quality components enable them to be confidently specified for the most demanding environments.

The provision of insect screens at door and window openings is a legal requirement in areas where food is prepared for public consumption, such as restaurants, works canteens, schools, hospitals and public buildings. Our Insect screens comply with the relevant Health and Safety regulations, and all frame sections are manufactured from hygienic white powder-coated aluminium extrusions. The PVC coated glass fibre mesh is rot-proof and flame-retardant.

The greatly enhanced interior environment provided by screens is an important contributor to the quality of life in many situations, both residential and commercial. The screens are unobtrusive, with simple and attractive detailing and quality components. The full range is distributed globally through a network of partners providing an unrivalled level of support, with experienced installation and service teams to exceed your expectations.

<b>F30 Sidewinder</b>	<b>43</b>
<b>F32 Spring</b>	<b>44</b>
<b>F40 Single Door</b>	<b>45</b>
<b>F40D Double Door</b>	<b>45</b>



this insect screen range comes with a Full Lifetime Warranty as standard.





## F30 Sidewinder

### Features:

The F30 retractable insect screen utilises a simple bead-chain sidewinder control as standard. White metal universal brackets for secure top fixing with powder-coated extruded aluminium cassette and side guide channels. Rot-proof PVC coated fibreglass mesh is locked into the barrel and bottom bar profile.

### Benefits:

The discreet yet attractive profile of the F30 roll-up system provides a perfect solution for almost all types of window or door openings. A strong focus on a trouble-free quality mechanism with high-grade nylon fittings ensures consistency of operation.

### Specification:

The F30 retractable insect screen with sidewinder operation. Roll-up flame retardant, rot-proof PVC coated fibreglass mesh within white powder-coated aluminium cassette, guide channels and bottom bar. Supported by sturdy metal brackets and incorporating plastic control chain.

Please refer to NBS Plus N10 240.

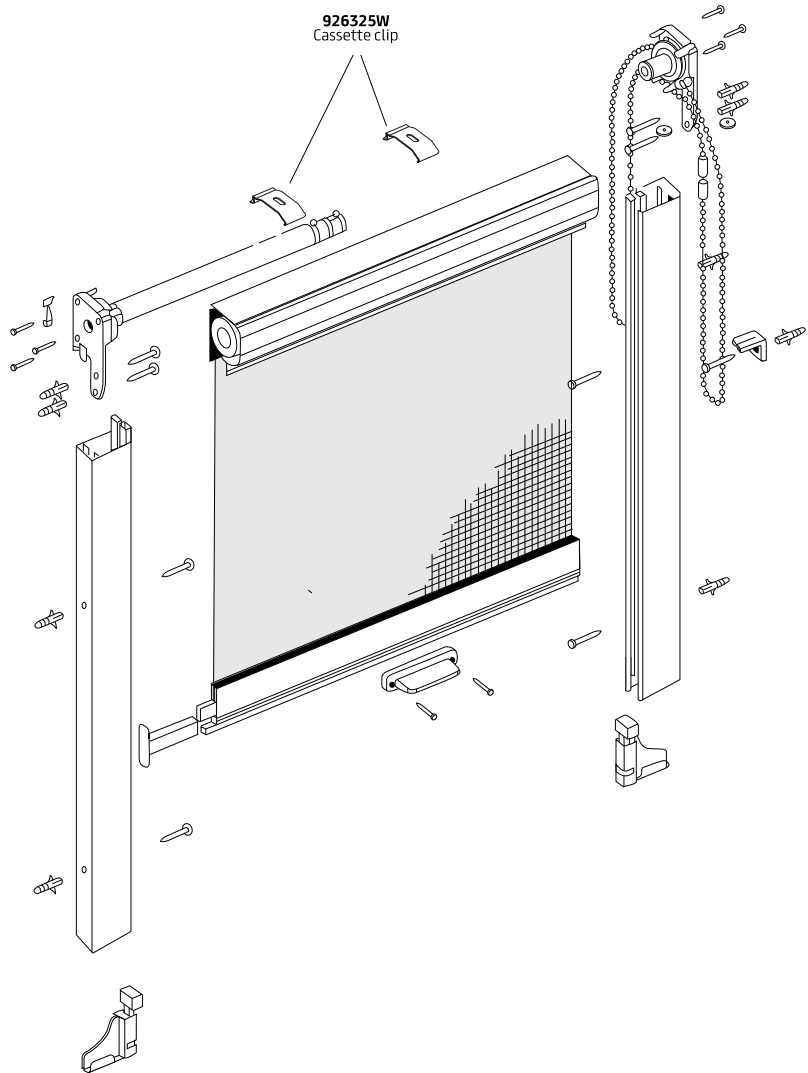

## Insect Screen Specification Guide

Model	Min Width	Max Width	Min Drop	Max Drop	Max M <sup>2</sup>
F30	800	1600	400	2500	3.5



# Insect Screens



## F32 Spring

### Features:

The F32 retractable insect screen with advanced slow-rise spring control ensures smooth and quiet operation. White metal universal brackets for secure top fixing with powder-coated extruded aluminium cassette and side guide channels. Rot-proof PVC coated fibreglass mesh is locked into the barrel and bottom bar profile.

### Benefits:

The discreet yet attractive profile of the F32 roll-up system will complement the décor of many interiors. Coupled with the ease of the advanced spring operation, this system is perfectly suited to a wide range of both commercial and domestic applications. A strong focus on a trouble-free quality mechanism with high-grade nylon fittings ensures consistency of performance.

### Specification:

The F32 retractable insect screen with advanced slow-rise spring operation. Vandal resistant spring and decelerator mechanism is housed within white powder-coated aluminium cassette. Roll-up flame retardant, rot-proof PVC coated fibreglass mesh held securely inside guide channels and bottom bar. Supported by sturdy metal brackets.

Please refer to NBS Plus N10 240.

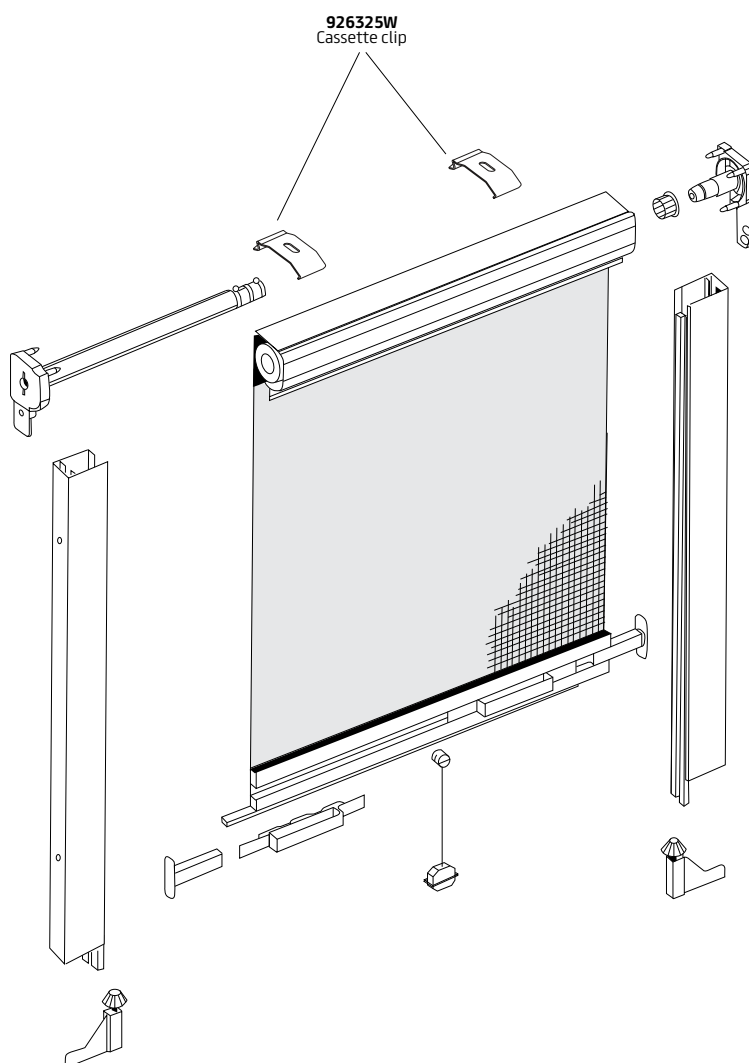

## Insect Screen Specification Guide

Model	Min Width	Max Width	Min Drop	Max Drop	Max M <sup>2</sup>
F32	600	1800	400	2500	3.5



## F40 Single Door F40D Double Door

### Features:

The F40 horizontally retractable insect screen with advanced slow-rise spring control ensures smooth and quiet operation. Available as single door unit (F40) or double door unit (F40D) as applicable. White metal universal brackets for secure top fixing with powder-coated extruded aluminium cassette and side guide channels. Rot-proof PVC coated fibreglass mesh is locked into the barrel and bottom bar profile.

### Benefits:

The slim, unobtrusive profile of the F40 roll-up system provides a suitable solution for doorways and large window openings in areas where food preparation is carried out. The 43mm cassette units will complement the décor of many interiors and the advanced spring operation ensures a reliable, consistency of use.

### Specification:

The F40/F40D horizontally retractable single/double insect screen unit with advanced slow-rise spring operation. Vandal resistant spring and decelerator mechanism is housed within white powder-coated aluminium cassette. Roll-up flame retardant, rot-proof PVC coated fibreglass mesh held securely inside guide channels and bottom bar. Supported by sturdy metal brackets.

Please refer to NBS Plus N10 240.

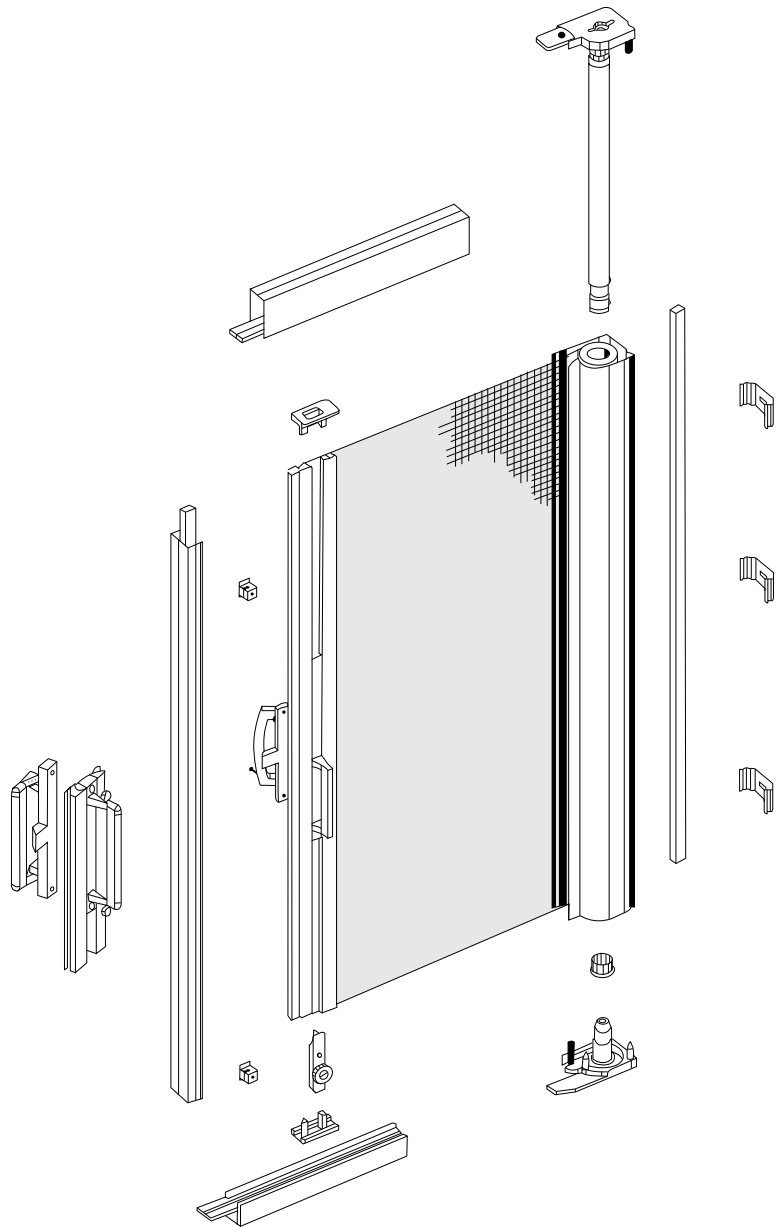

## Insect Screen Specification Guide

Model	Min Width	Max Width	Min Drop	Max Drop	Max M <sup>2</sup>
F40	400	1200	1000	2500	3.0
F40D	800	2500	1000	2500	6.0

## Vertical Blinds

All blinds are carefully built to exacting standards, to give years of trouble-free service. The superior design features and quality components enable them to be confidently specified for the most demanding applications.

Vertical blinds are designed for intensive use and are frequently to be seen in busy public areas such as hospitals and schools, as well as commercial and residential environments.

The Vertical blind programme is very comprehensive, ranging from slim premium profiled units to heavy-duty electrically controlled blinds.

The fabrics programme encompasses a vast range of fabrics, all of which are flame-retardant to government standards. Fabric types include dim-out, black-out, solar reflective, sunscreen and solar film.

All our blinds are supplied in a fully made to measure form, completely ready for ease of installation on site. Some systems are also available in a comprehensive individual component form - for ease of use within any in-house manufacturing facility.

The full range is distributed globally through a network of partners providing an unrivalled level of support, with experienced installation and service teams to exceed your expectations

<b>VL30 Premium Profile</b>	<b>47</b>
<b>VL60 Mono</b>	<b>48</b>
<b>VL64 Crank</b>	<b>49</b>
<b>VL65 Electric 230v AC</b>	<b>50</b>



this vertical blind range comes with a Full Lifetime Warranty as standard.





## VL30 Premium Profile

### Features:

The VL30 premium profile vertical blind has a 40 x 25mm premium white aluminium head-rail with top-fix brackets and wheeled carrier trucks. The constant transport of the louvres is guaranteed by the precision made aluminium spindle shaft. Metal control chain operation with built in slip clutch for louvre tilt. Louvres are supplied in 127mm, 89mm, and 63mm widths with weights and white stabilising chain.

### Benefits:

Robust and with a high quality level of performance, including smooth and quiet operation, the VL30 remains still visually pleasing to the eye. The comprehensive truck options satisfy the most demanding environments whether it's residential or commercial. This system has been designed to offer a trouble-free solution throughout its lifetime.

**Approved to work with the YewdaleKestrel® Anti-Ligature system.**

### Options:

VL31 wand control; Spring metal trucks; Enclosed weights; VL30S sloping; Face fix brackets.

### Specification:

The VL30 premium profile vertical blind with chain control. 40 x 25mm white powder-coated aluminium head-rail with tilt control by metal control chain and cord draw operation. Replaceable truck hooks, or spring metal truck hooks, with 127/ 89/ 63mm louvres in flame retardant fabric from the range, complete with louvre weights and white stabilising chain.

Please refer to NBS Plus N10 240.

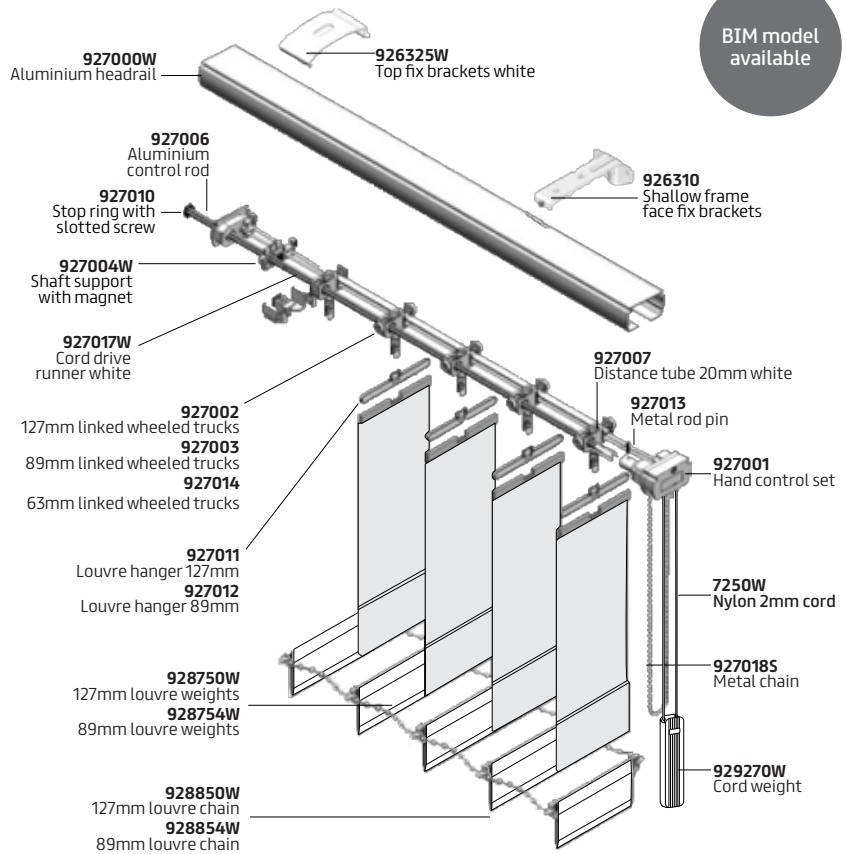

BIM model available



## have you seen all our fabrics?

All our fabric selectors make choosing easy. Have you got the full set?

## Vertical Blind Specification Guide

Model	Min Width	Max Width	Max Drop	Max M <sup>2</sup>
VL30 Premium profile	300	4550	4550	20.7
VL31 Premium profile	300	4550	4550	20.7

Based on fabric weight of 220g/m<sup>2</sup>, e.g. Thames. Use of heavier fabrics may require appropriate reductions.

# Vertical Blinds



BIM model available

## VL60 Mono

### Features:

The VL60 vertical blind has a 45 x 36.5mm white aluminium head-rail with top-fix brackets and wheeled carrier trucks. The constant transport of the louvres is guaranteed by a precise aluminium spindle shaft. Mono control operation by metal control chain with built in slip clutch for both louvre tilt and draw. Louvres are supplied in 127mm and 89mm widths with weights and white stabilising chain.

### Benefits:

The VL60 offers the ease of mono control - a comfortable gear change mechanism with large chain wheel caters for continuous transport and automatically switches from tilting to traversing. By pulling the metal ball chain the louvres tilt and then traverse. The strong head-rail and the wheeled carrier trucks are designed to withstand the rigours of intensive use, whilst the ingenious mechanism allows precise control of light transmission. A robust, long-lasting blind, and one that is delightfully simple to operate.

**Approved to work with the YewdaleKestrel® Anti-Ligature system.**

### Options:

VL60S sloping head-rail versions; Face fix brackets; Extension brackets; Enclosed weights.

### Specification:

The VL60 mono vertical blind with chain control, 45 x 36.5mm white powder-coated aluminium head-rail with mono control by metal control chain. 127/ 89mm louvres in flame retardant fabric from the range, complete with louvre weights and white stabilising chain.

Please refer to NBS Plus N10 240.

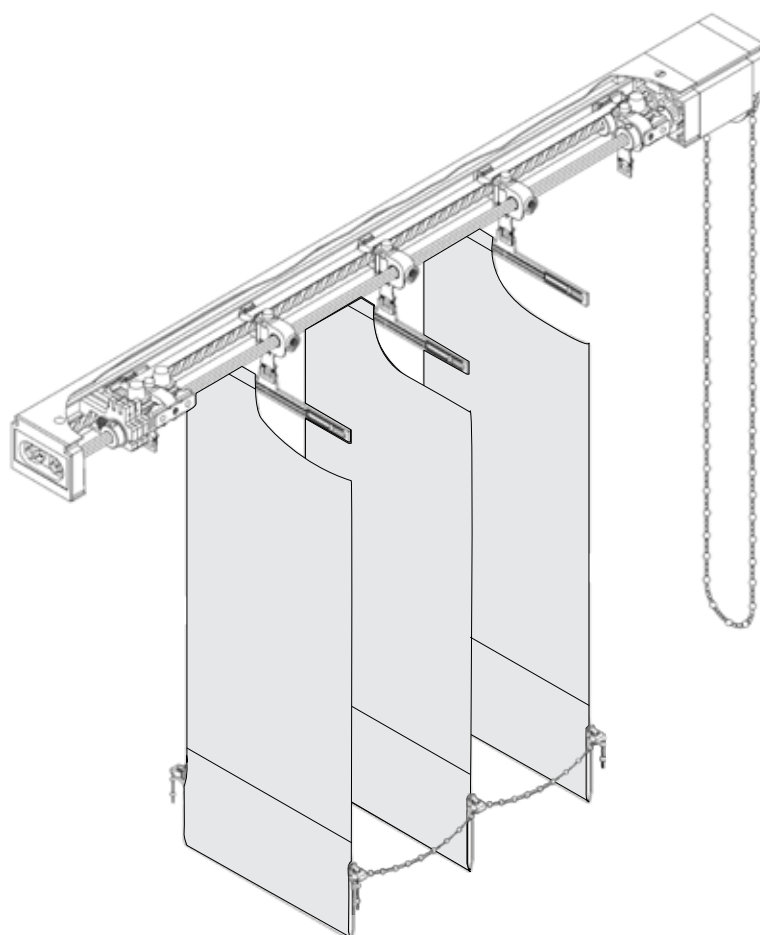

## Vertical Blind Specification Guide

Model	Min Width	Max Width	Max Drop	Max M <sup>2</sup>
VL60 Mono control	300	4550	3200	14.5

Based on fabric weight of 220g/m<sup>2</sup>, e.g. Thames. Use of heavier fabrics may require appropriate reductions.



## VL64 Crank

### Features:

The VL64 vertical blind has a 45 x 36.5mm white aluminium head-rail with top-fix brackets and wheeled carrier trucks. The constant transport of the louvres is guaranteed by a precise aluminium spindle shaft. Fixed crank operation with built in slip clutch for both louvre tilt and draw. Louvres are supplied in 127mm, and 89mm widths with weights and white stabilising chain.

### Benefits:

The VL64 offers the ease of mono control - a comfortable gear change to ensure the continuous movement, automatically switching from tilting to traversing. By turning the crank handle the louvres tilt and then traverse. The strong head-rail and wheeled carrier trucks are designed to withstand the rigours of intensive use, whilst the ingenious mechanism allows a precise control of light transmission. A long-lasting blind, and delightfully simple to operate.

**Approved to work with the YewdaleKestrel® Anti-Ligature system.**

### Options:

VL64S sloping head-rail versions; Face fix brackets; Extension brackets; Enclosed weights; Detachable crank.

### Specification:

The VL64 mono vertical blind with crank operation. 45 x 36.5mm white powder-coated aluminium head-rail with mono control by crank handle. 127/ 89mm louvres in flame-retardant fabric from the range, complete with louvre weights and white stabilising chain.

Please refer to NBS Plus N10 240.

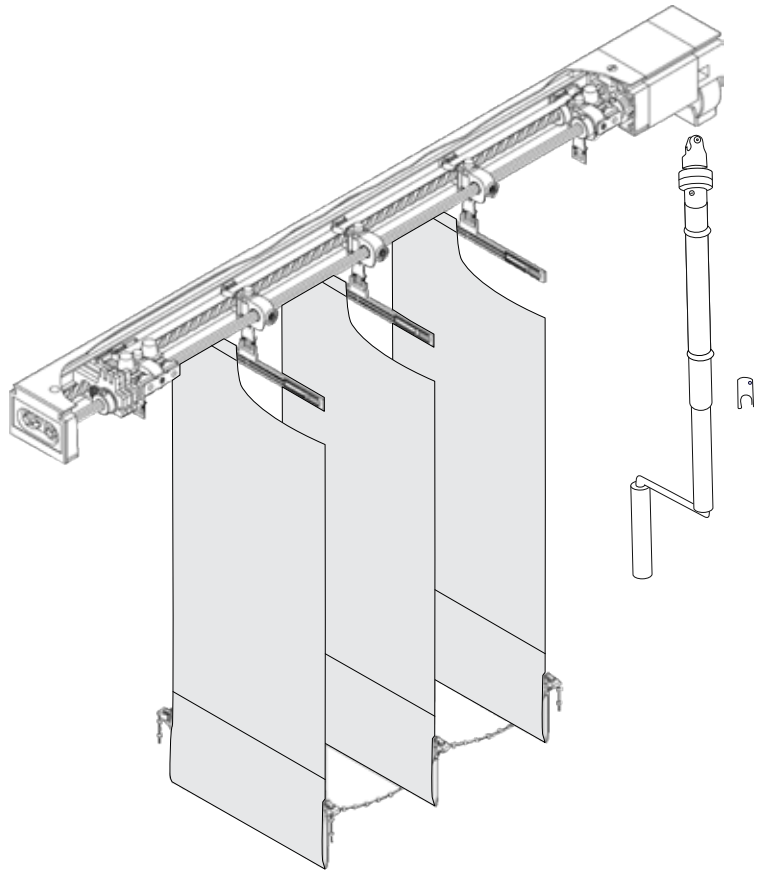

**have you seen all our fabrics?**

All our fabric selectors make choosing easy. Have you got the full set?

## Vertical Blind Specification Guide

Model	Min Width	Max Width	Max Drop	Max M²
VL64 Crank control	300	4550	3200	14.5

Based on fabric weight of 220g/m², e.g. Thames. Use of heavier fabrics may require appropriate reductions.

# Vertical Blinds



## VL65 Electric 230v AC

### Features:

The VL65 vertical blind has a 45 x 36.5mm white aluminium head-rail with top-fix brackets and wheeled carrier trucks. The constant transport of the louvres is guaranteed by a precise aluminium spindle shaft. Electric 230v AC operation with built in slip clutch controls both louvre tilt and draw. Louvres are supplied in 127mm, and 89mm widths with weights and white stabilising chain. Single or split draw.

### Benefits:

The VL65 offers the ease of mono control - a precision driven gearbox to ensure continuous movement and one which automatically switches from tilting to traversing. By operating the electric control switch the louvres tilt and then traverse. The strong head-rail and wheeled carrier trucks are designed to withstand the rigours of intensive use, whilst the ingenious mechanism allows precise control of light transmission. Another robust, long-lasting blind.

### Options:

VL65S sloping head-rail versions; Face fix brackets; Extension brackets; Enclosed weights; Radio remote control; Group control.

### Specification:

The VL65 electric vertical blind with 230v AC electric motor, 45 x 36.5mm white powder-coated head-rail with mono control by electric operation. 127/89mm louvres in flame retardant fabric from the range, complete with louvre weights and white stabilising chain.

Please refer to NBS Plus N10 240.

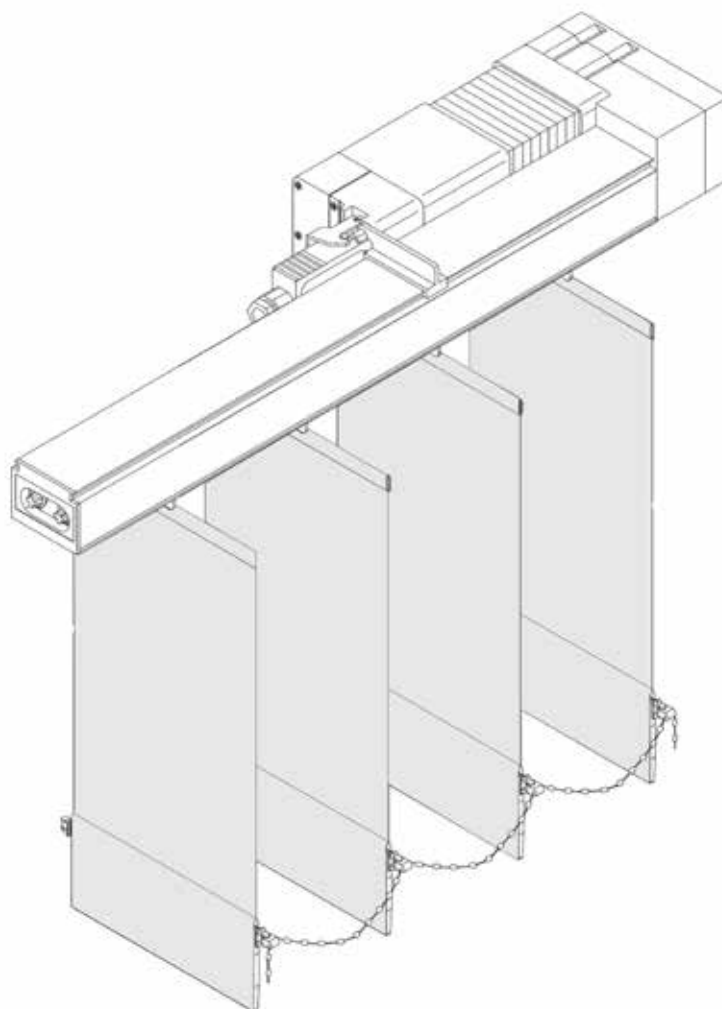

## Vertical Blind Specification Guide

Model	Min Width	Max Width	Max Drop	Max M <sup>2</sup>
VL65 Electric	400	4550	3200	14.5

Based on fabric weight of 220g/m<sup>2</sup>, e.g. Thames. Use of heavier fabrics may require appropriate reductions.





## Venetian Blinds

All blinds are carefully built to exacting standards, to give years of trouble-free service. The superior design features and quality components enable them to be confidently specified for the most demanding applications.

Venetian blinds are designed for intensive use and are frequently to be seen in busy public areas such as offices and showrooms, as well as other commercial and residential environments.

Venetian blinds are the premium shading solution that provides the control and quality expected, whilst never compromising on the style. These venetian blinds utilise durable aluminium slats that come with a choice of over 80 colours, meaning that they can fit comfortably into nearly any environment. The headrails, bottom bars, ladders and cords are coordinated with the choice of colour to allow for seamless integration into the room.

The innovative control systems allow for easy operation, and give excellent control over the amount of light entering the room. The traditional three cord mechanism of the VN25 provides a robust and smooth movement whilst the VN25S's unique mono control gives a clean and neat appearance.

Our venetian blinds have an extra deep headrail that allows for wider installations, requiring less brackets. For installations with a drop of over two metres, a side guiding option is available.

**VN25 Tilt Wand**

**53**

**VN25S Mono Chain**

**54**



this venetian blind range comes with a Full Lifetime Warranty as standard.





# VN25 Tilt Wand

## Features:

The VN25 Venetian Blind includes, as standard, a premium extra depth headrail, (27 x 24mm) with top fix turning fixing key brackets. The quality aluminium slats are 25mm wide with a 0.21mm thickness. The movement of the 25mm slats is guaranteed by the traditional 3 cord lock mechanism and the aluminium slats are controlled with a tilt wand mechanism for precision angles.

## Benefits:

Robust and vibrant with a high quality level of performance, including smooth operation, the VN25 is visually pleasing to the eye. The comprehensive colour options satisfy almost every environment whether it be residential or commercial. The extra deep headrail can accommodate wider installations and requires less brackets. This system has been designed to offer a trouble-free solution throughout its lifetime.

## Options:

The VN25 system has a vast range of coloured and textured aluminium slats. Which can be co-ordinated with headrails, bottom bars, ladders and cords. A side guiding option is available for installations with a drop of over 2 metres.

## Specification:

The VN25 premium Venetian blind with tilt wand and cord control, 27 x 24mm colour coated aluminium headrail in 44 colours and closed rail bottom bars also in 44 colours, both with colour co-ordinated ladders and cords. Aluminium 25mm slats with 0.21mm thickness with an impressive collection of 81 colours and textures.

Please refer to NBS Plus N10 240.

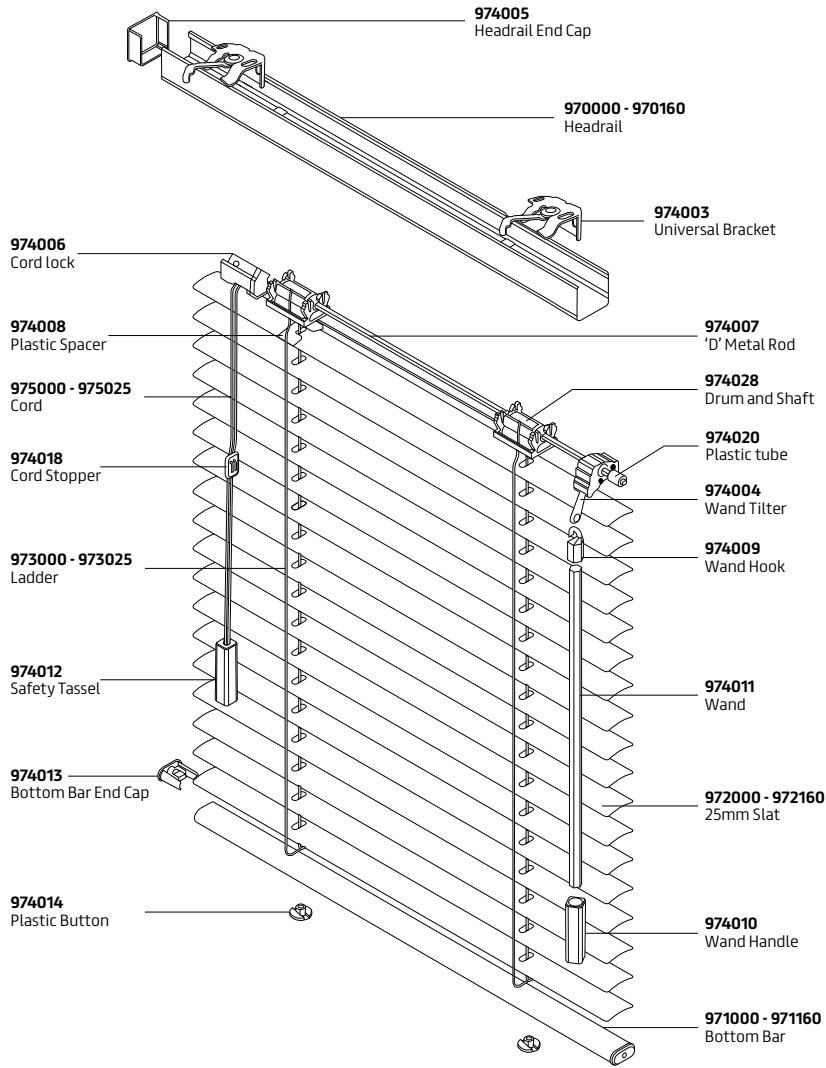

# Venetian Blind Specification Guide

Model	Min Width	Max Width	Max Drop	Max M <sup>2</sup>
VN25	290	3000	3000	6.25

# Venetian Blinds



## VN25S Mono Chain

### Features:

The VN25S Venetian Blind includes, as standard, a premium extra depth headrail, (27 x 24mm) with top fix turning fixing key brackets. The quality aluminium slats are 25mm wide with a 0.21mm thickness. The unique mono chain control only requires one mechanism for the whole system. Therefore the blind is easily operated from one end giving a neater appearance overall. This innovative mechanism ensures the blind constantly stays level when lifted and slats can be angled more accurately.

### Benefits:

Robust and vibrant with a high quality level of performance, including smooth operation, the VN25S is visually pleasing to the eye. The comprehensive colour options satisfy almost every environment whether it is residential or commercial. The extra deep headrail can accommodate wider installations and requires less brackets. This system has been designed to offer a trouble-free solution throughout its lifetime.

### Options:

The VN25S system has a vast range of coloured and textured 25mm aluminium slats, which can be co-ordinated with headrails, bottom bars, ladders and cords. A side guiding option is available for installations with a drop of over 2 metres.

### Specification:

The VN25S premium Venetian blind with mono chain control, 27 x 24mm colour coated aluminium headrail in 44 colours and closed rail bottom bars also in 44 colours, both with colour co-ordinated ladders and cords. Aluminium 25mm slats with 0.21mm thickness with an impressive collection of 81 colours and textures.

Please refer to NBS Plus N10 240.

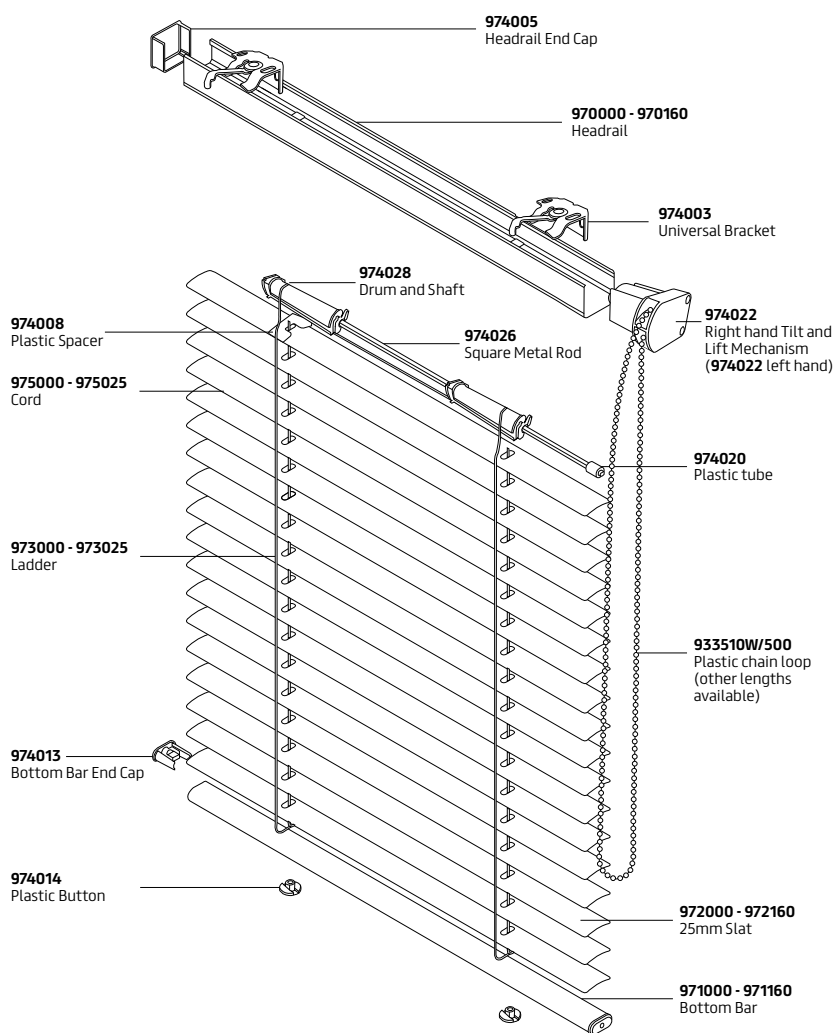

## Venetian Blind Specification Guide

Model	Min Width	Max Width	Max Drop	Max M <sup>2</sup>
VN25S	290	2500	2500	5



C/GBZ 1970 reference by Site Agency			
(707)	X		



Penraevon Industrial Estate,  
Penraevon Ave, Leeds, LS7 2AW

**Call** 0113 347 2347

**Email** [info@commercialblindsuk.com](mailto:info@commercialblindsuk.com)

**Visit** [commercialblindsuk.com](http://commercialblindsuk.com)

For more information on  
all products, please call  
the sales department.